

BEFCO®

Operator's Manual

SICKLE BAR MOWERS

BSB-060, BSB-074, BSB-084, BSB-096, BSB-106

(serial #289769 & above)

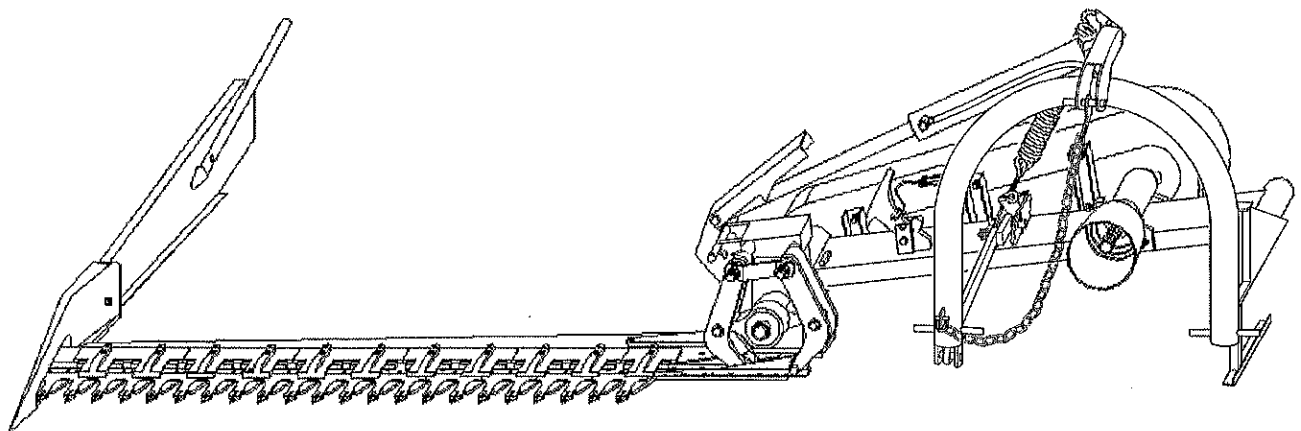

The operator's manual is a technical service guide and must always accompany the machine.

Manual 960-391B

June 2012

SAFETY

Take note! This safety alert symbol found throughout this manual is used to call your attention to instructions involving your personal safety and the safety of others. Failure to follow these instructions can result in injury or death.



This symbol means:
ATTENTION!
BECOME ALERT!
YOUR SAFETY IS INVOLVED!

Signal Words

Note the use of the signal words DANGER, WARNING and CAUTION with the safety messages. The appropriate signal words for each have been selected using the following guidelines:



DANGER: Indicates an imminently hazardous situation that, if not avoided, will result in death or serious injury.



WARNING: Indicates a potentially hazardous situation that, if not avoided, could result in death or serious injury, and includes hazards that are exposed when guards are removed. It may also be used to alert against unsafe practices.



CAUTION: Indicates a potentially hazardous situation that, if not avoided, may result in minor or moderate injury.

INDEX

1 - GENERAL INFORMATION	4
1.01 - General	4
1.02 - Warranty Information	4
1.03 - Model and Serial Number ID	5
2 - SAFETY PRECAUTIONS	6
2.01 - Preparation	6
2.02 - Starting and Stopping	6
2.03 - Messages and Signs	7
3 - OPERATION	10
3.01 - Operational Safety	10
3.02 - Setup	12
3.03 - Assembly Instructions	12
3.04 - Pre-Operational Check	16
3.05 - Attaching to the Tractor	16
3.06 - Start Up	18
3.07 - Working Speed	19
3.08 - Operating Techniques	19
3.09 - Uneven Terrain	23
3.10 - Hydraulic cylinder flow valve adjustment	24
3.11 - Angle of Cut	24
3.12 - Removing Mower from Tractor	25
3.13 - Transport	25
4 - MAINTENANCE	26
4.01 - Maintenance Safety	26
4.02 - Service	27
4.03 - Driveline	28
5 - REPAIR PROCEDURES	31
5.01 - Blade Replacement	31
5.02 - Suggested Spare Parts	32
5.03 - Storage	33
6 - TROUBLESHOOTING	34
7 - PRE-DELIVERY CHECKLIST	35
8 - WARRANTY	36
PARTS MANUAL	41

1 - GENERAL INFORMATION

Thank you and congratulations for having chosen our implement. Your new sickle bar mower is a technologically advanced machine constructed of high quality, sturdy components that will fulfill your working expectations. Read this manual carefully. It will instruct you on how to operate and service your implement safely and correctly. Failure to do so could result in personal injury and/or in equipment damage.

1.01 - General

The implement described in this manual is to be used with tractors with PTO at 540 rpm and clockwise rotation.



CAUTION: Always ensure that the coupling of the implement with the tractor is done at the same PTO speed and direction of rotation. Do not operate this implement at a PTO speed or direction of rotation other than that shown on the implement. Serious damage can occur to the machine and/or the operator.



CAUTION: Unless otherwise specified, all hardware is metric. Use only metric tools on metric hardware. Other tools that do not fit properly can slip and cause injury.



CAUTION: Right hand and left hand sides of the implement are determined by facing in the direction the implement will travel when going forward (see fig. 2).

1.02 - Warranty Information

Carefully read the Warranty section¹, detailing coverage and limitations of this warranty. **Warranty** is provided for customers who operate and maintain their equipment as described in this manual. Warranty registration is accomplished by the dealer by completing and forwarding the **Warranty Registration** form to the Company, along with a copy of the dealer's invoice. It is in your best interest to insure that this has been done.

Warranty does not cover the following:

1. Cleaning, transporting, mailing and service call charges.

¹ See Chapter 8 - Warranty.

2. Normal wear items such as belts, blades, bearings, drivelines, shear pins, slip clutches, etc.
3. Depreciation or damage caused by normal wear, accidents, improper maintenance, improper protection or improper use.
4. The use of non-original spare parts and accessories.

Your Authorized Company Dealer has genuine parts in stock. Only these approved replacement parts should be used.

This limited warranty covers defective material and workmanship. The cost of normal maintenance or repairs for accidents or improper use and related labor will be borne by the owner.

1.03 - Model and Serial Number ID

Attached to the frame is an ID plate showing the model and the serial number. Record your implement model and serial number in the space provided below. Your dealer needs this information to give you prompt, efficient service when you order parts.

BEFCO	1781 S. Wesleyan Blvd. — P.O. Box 6036 Rocky Mount, N.C. 27802 — U.S.A. Tel: 1.252.977.9920 Fax: 1.252.977.9718
MODEL:	<input type="text"/>
SERIAL:	<input type="text"/>
VERSION:	<input type="text"/>

2 - SAFETY PRECAUTIONS

Safety is the primary concern in the design and manufacture of our products. Unfortunately our efforts to provide safe equipment can be wiped out by a single careless act of an operator.

In addition to the design and configuration of equipment, hazard control and accident prevention are dependent upon the awareness, concern, prudence and proper training of personnel involved in the operation, transport, maintenance and storage of equipment. It is the operator's responsibility to read and understand all safety and operating instructions in the manual and to follow these.

Allow only properly trained personnel to operate the implement. Working with unfamiliar equipment can lead to careless injuries. Read this manual, and the manual for your tractor, before assembly or operation, to acquaint yourself with the machines. It is the owner's responsibility, if this machine is used by any person other than yourself, is loaned or rented, to make certain that the operator, prior to operating, reads and understands the operator's manuals and is instructed in safe and proper use.

2.01 - Preparation



1. Before operating equipment read and understand the operator's manual and the safety signs (see fig. 2).
2. Thoroughly inspect the implement before initial operation to assure that all packaging materials, i.e. wires, bands, and tape have been removed.
3. Personal protection equipment including hard hat, safety glasses, safety shoes, and gloves are recommended during assembly, installation, operation, adjustment, maintaining and/or repairing the implement.
4. Operate the implement only with a tractor equipped with an approved Roll-Over-Protective-System (ROPS). Always wear your seat belt. Serious injury or even death could result from falling off the tractor.
5. Clear area to be cut of stones, branches or other debris that might be thrown, causing injury or damage.
6. Operate only in daylight or good artificial light.
7. Ensure implement is properly mounted, adjusted and in good operating condition.
8. Ensure that all safety decals are properly installed and in good condition.

2.02 - Starting and Stopping



1. Be sure that no one is near the machine prior to engaging or while the machine is working.

2. Be sure the tractor is in "Neutral" before starting engine.
3. Never use the lifting controls when standing between the tractor and linkage.
4. Mower operating power is supplied from tractor PTO. Refer to your tractor manual for PTO engagement and disengagement instructions. Operate PTO at approximately 400 rpm, never operate PTO at speeds above 540 rpm. Know how to stop the tractor and mower quickly in case of an emergency.
5. When engaging PTO, the engine rpm should always be low. Once engaged and ready to start cutting, raise PTO speed to 400 rpm and maintain throughout cutting operation.
6. Check the tractor master shield over the PTO stub shaft. Make sure it is in good condition and fastened securely to the tractor. Purchase a new shield if old shield is damaged or missing.
7. After striking an obstacle, disengage the PTO, shut the tractor down and thoroughly inspect for damage before restarting.
8. To park the vehicle safely, stop vehicle on a level surface (not on a slope), disengage PTO, engage the parking brake, stop the engine, remove the key, and wait for engine and all moving parts to stop before leaving the operator's seat.
9. Stay clear of rotating drivelines. Entanglement in rotating driveline can cause serious injury or death. Wear close fitting clothing. Stop the engine and be sure PTO driveline is stopped before getting near it.

2.03 - Messages and Signs



1. Read and adhere to all safety and operating decals on this machine (**see fig. 2**).
2. Before dismounting tractor: Allow moving parts to stop, stop engine, set brake and remove the key of unattended equipment.
3. Keep safety decals in place and in good condition.
4. Keep guards and shields in place and in good condition.
5. Do not use with bystanders in area.
6. Allow no riders on tractor or implement.
7. Allow moving parts to stop before repair.
8. Securely support implement before working underneath.

Additional warning and operating decals are available at no extra charge. Please specify model and serial number when ordering.

Fig. 2 - Safety decals - implement; replace immediately if damaged.

⚠ WARNING

High-pressure hydraulic oil leaks can penetrate skin resulting in serious injury, gangrene or death.

- Check for leaks with cardboard; never use hand.
- Before loosening fittings: lower load, release pressure, and be sure oil is cool.
- Consult physician immediately if skin penetration occurs.

999-1005

⚠ DANGER

Avoid injury from PTO

- Entanglement can cause serious injury or death.
- Keep driveline shields in place & in good condition.
- Keep hands, feet and clothing away.
- Operate only with 540 RPM.

999-1008

⚠ DANGER

Keep away sharp blades

- Do not put hands or feet near the cutterbar. Blade contact can result in serious injury.
- Stay away until all motion has stopped and the mower is securely blocked up.
- Keep fingers clear of cutterbar when folding cutterbar for transport.

999-1020

⚠ WARNING

Crushing and Pinching Hazard

- Be extremely careful handling various parts of the hitching mechanism. They are heavy and hands, fingers, feet, and other body parts could be crushed or pinched between tractor and implement.
- Operate tractor controls from tractor seat only.
- Do not stand between tractor and implement when tractor is in gear.
- Make sure parking brake is engaged before going between tractor and implement.
- Stand clear of machine while in operation or when it is being raised or lowered.

Failure to follow these instructions could result in serious injury or death.

999-1070

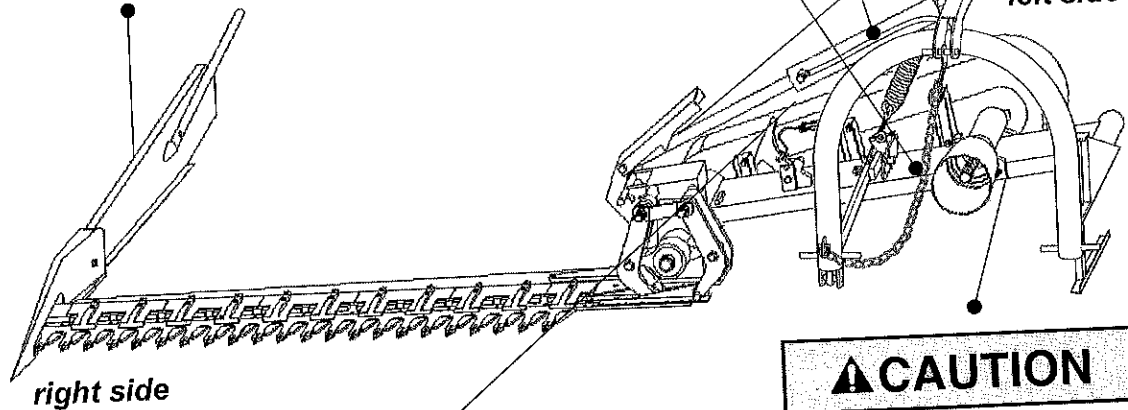

⚠ DANGER

Replace shields before using machine

999-1111

⚠ CAUTION

To avoid serious injury:

- Read Operator's Manual before operating, servicing or repairing equipment. Follow all safety rules and instructions. (Manuals are available from your selling dealer).
- Know location and function of controls.
- Keep all shields in place and in good condition.
- Stay clear of power driven parts.
- Never allow riders.
- Never allow children or untrained persons to operate equipment.
- Keep bystanders at a safe distance away from mower during operation.
- Before mowing, clear area of objects that may be thrown by blades.
- Use extra caution on uneven terrain. Decrease speed when turning.
- Tractor must be equipped with a Roll-Over-Protection-System (ROPS) and seatbelt.
- Keep foldable ROPS systems in the "locked up" position at all times.
- Keep seatbelt securely fastened.

Before dismounting or servicing

- Shut off engine and remove key.
- Lock parking brake.
- Wait for all movement to stop
- Lower or block up mower.

999-1165

Safety decals - driveline; replace immediately if damaged.

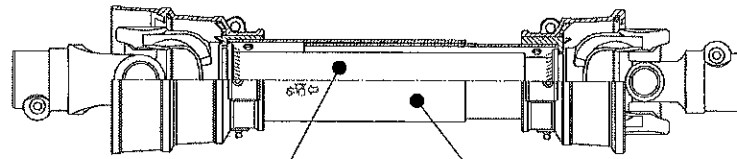

placed on outer tube



placed on outer shield

3 - OPERATION

You have purchased a sickle bar mower designed for the mowing of fields, ditch banks and along ponds. The sickle bar mowers can be used with tractors from 16 up to 75 HP and come in working widths of 60", 74", 84", 96" and 106". The double action sickle bar mowers come complete with an adjustable top link that ensures a sharp clean cut. The double action sickle bar allows for a maximum working speed of up to 6.5 mph. Simple but tough construction along with a heavy duty PTO, weight compensation spring, transport blade protection and a safety release which protects the unit from obstructions in the field, all provide for a unit that will give years of trouble free service. Sickle bar mowers come standard with a hydraulic cylinder that makes it easy to raise the bar for mowing at an angle or for transport and storage. With the capability of mowing 90° up -55° down (-35° down on BSB-060) along with the low horsepower requirements make the sickle bars capable of handling jobs that are not recommended for conventional disc mowers.



WARNING: The sickle bar is suitable only for the uses indicated. Any other use different from that described in these instructions could cause damage to the machine and represent a serious hazard for the user.

3.01 - Operational Safety



CAUTION: Our mowers are designed considering safety as the most important aspect and are the safest available in today's market. Unfortunately, human carelessness can override the safety features built into our machines. Injury prevention and work safety, aside from the features on our mowers, are very much due to the responsible use of the equipment. It must always be operated prudently following with great care, the safety instructions laid out in this manual.



1. The use of this equipment is subject to certain hazards which cannot be prevented by mechanical means or product design. All operators of this equipment must read and understand this entire manual, paying particular attention to safety and operating instructions, prior to using.
2. Do not operate the tractor and implement when you are tired, sick or when using medication.
3. Keep all helpers and bystanders at least 50 feet from the implement. Only properly trained people should operate this machine.

4. Accidents are most likely to occur with machines that are loaned or rented to someone who has not read the operator's manual and is not familiar with the implement.
5. The majority of accidents involve entanglements on the driveline, injury of bystanders from the mower blades, and operators being knocked off the tractor by low hanging limbs and then being run over by the mower. Accidents are most likely to occur with machines that are loaned or rented to someone who has not read the operator's manual and is not familiar with a sickle bar mower.
6. Always stop the tractor, set brake, shut off the tractor engine, remove the ignition key, lower implement to the ground and allow mower blades to come to a complete stop before dismounting tractor. Never leave equipment unattended with the tractor running.
7. Never place hands or feet near mower with tractor engine running or before you are sure all motion has stopped. Stay clear of all moving parts.
8. Do not allow riders on the mower or tractor at any time. There is no safe place for riders.
9. Do not operate unless all personnel, livestock and pets are several feet away to prevent injury by thrown objects.
10. Before backing up, disengage the mower and look behind carefully.
11. Install and secure all guards and shields before starting or operating.
12. Keep hands, feet, hair and clothing away from moving parts.
13. This mower is designed for use only on tractors with 540 rpm power take off.
14. Never operate tractor and mower under trees with low hanging limbs. Operators can be knocked off the tractor and then run over by the mower blades.
15. The moving parts of this machine have been designed and tested for rugged use. However, they could fail upon impact with heavy, solid objects such as steel guard rails and concrete abutments. Such impact could cause the broken objects to be thrown outward at very high velocities. To reduce the possibility of property damage, serious injury, or even death, never allow the cutting blades to contact such obstacles.
16. Frequently check mower blades. They should be sharp, free of nicks and cracks and securely fastened.
17. Stop mower immediately upon striking an obstruction. Turn engine off, remove key, inspect and repair any damage before resuming operation.
18. Stay alert for holes, rocks and roots in the terrain and other hidden hazards. Keep away from drop-offs.
19. Use extreme care and maintain minimum ground speed when transporting on hillside, over rough ground and when operating close to ditches or fences. Be careful when turning sharp corners.
20. Reduce speed on slopes and sharp turns to minimize tipping or loss of control. Be careful when changing directions on slopes. Do not start or stop suddenly on slopes. Avoid operation on steep slopes.
21. When using a unit, a minimum 20% of tractor and equipment weight must be on tractor front wheels. Without this weight, tractor could tip over, causing personal injury or death. The weight may be attained with a front end loader, front wheel weights, ballast in tires or front tractor weights. When attaining a minimum 20% of

- tractor and equipment weight on the front wheels, you must not exceed the ROPS weight certification. Weigh the tractor and equipment. Do not guess or estimate!
22. Inspect the entire machine periodically². Look for loose fasteners, worn or broken parts, and leaky or loose fittings.
 23. Use only the driveline supplied with the mower. Do not use it if it is missing any shield or safety protection.
 24. Pass diagonally through sharp dips and avoid sharp drops to prevent "hanging up" tractor and mower.
 25. Avoid sudden starts and stops while traveling up or downhill.
 26. Always cut down slopes; never across the face. Avoid operation on steep slopes. Slow down on sharp turns and slopes to prevent tipping and or loss of control.

3.02 - Setup

Notice to dealer: Pre-delivery setup and service including lubrication is the responsibility of the authorized dealer. It is up to him to assure that the machine is in perfect condition and ready to be used. It is his responsibility to ensure that the customer is aware of all safety aspects and operational procedures for the mower. He must also fill out the Pre-Delivery Checklist³ prior to delivering the mower.

3.03 - Assembly Instructions

For transport purposes implements are often shipped partially assembled. Follow the instructions below to assemble the sickle bar mower.



CAUTION: Stand clear of bands when cutting as they could be under sufficient tension to cause them to fly loose. Take care in removing bands and wire. They often have extremely sharp edges and cut very easily.

To assemble the support stand (see fig. 3):

1. Remove the roll pin (Ø6x50) from the support stand.
2. Remove the support stand from the frame shaft.
3. Insert the roll pin (Ø6x50) through the hole on the support stand until it protrudes from both sides.
4. Assemble the support stand on the machine, insert the locking pin (Ø8) and let the frame rest on it.

² See Chapter 4 - Maintenance.

³ See Chapter 7 - Pre-Delivery Checklist.

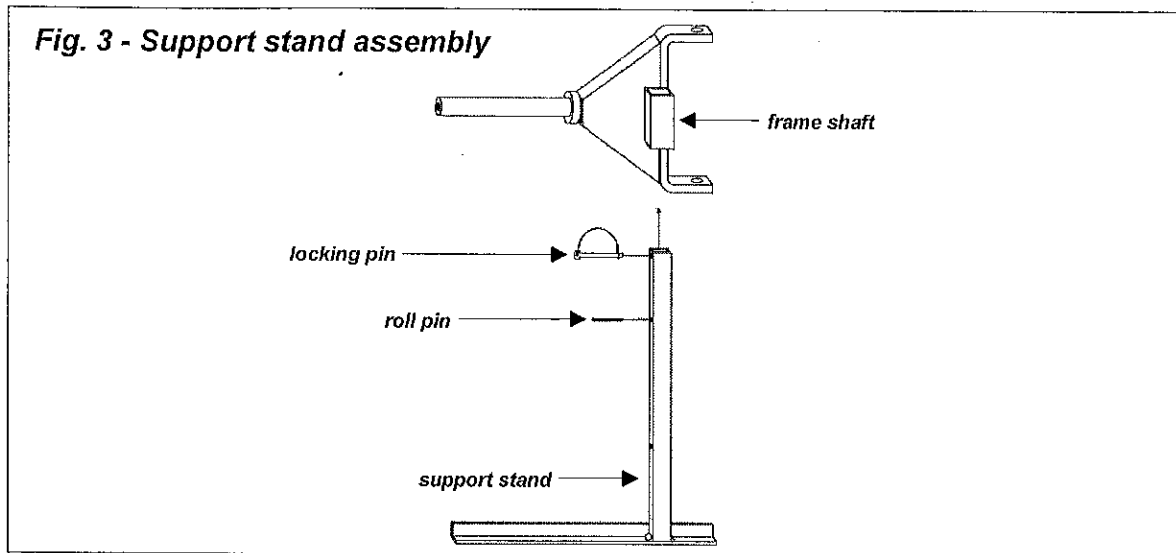

To install the spring (see fig. 4):

1. Attach one side of the spring to the cylinder attachment lever (see fig. 6).
2. Remove the elastic stop nut (M12) from the threaded eye bolt.
3. Hook up the threaded eye bolt (M12) to the hook welded on the frame.
4. Making sure that the long side of the spring attachment plate is the side connected to the spring, insert the threaded eye bolt through the other hole of the spring attachment plate.
5. Tighten the elastic stop nut (M12) to the threaded eye bolt.

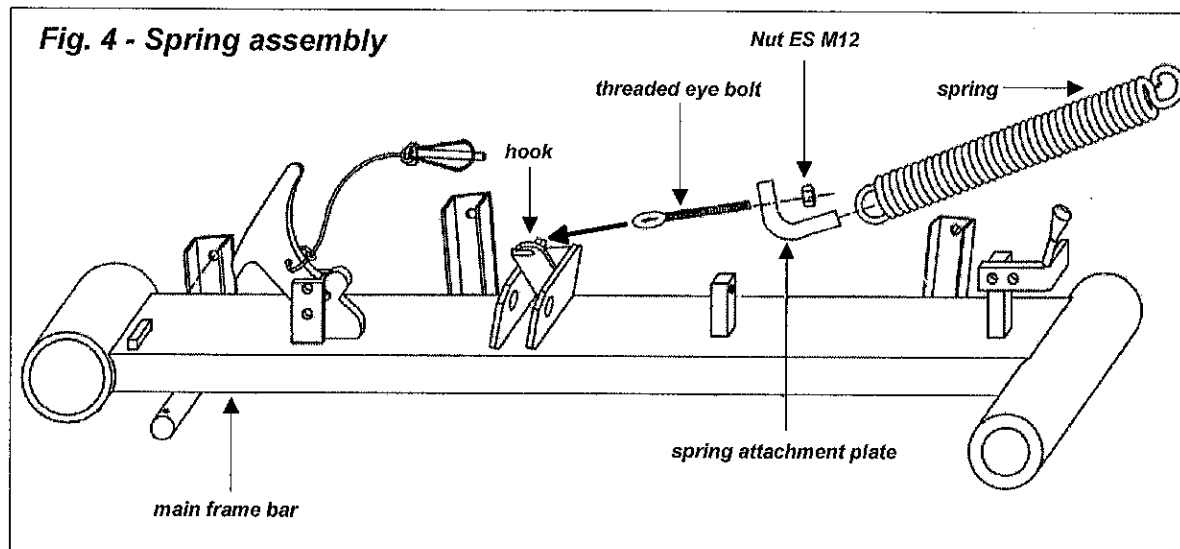

To assemble the safety release (see fig. 5):

1. Remove the roll pins ($\text{Ø}6 \times 50$) from the safety release pin on the main frame bar and on the safety release plate.

2. Assemble the safety release on one side to the three point hitch and on the other side to the frame making sure the spring is mounted on the frame side facing away from the driveline.
3. Reinstall the safety release pins and secure both sides with roll pins ($\text{Ø}6 \times 50$).

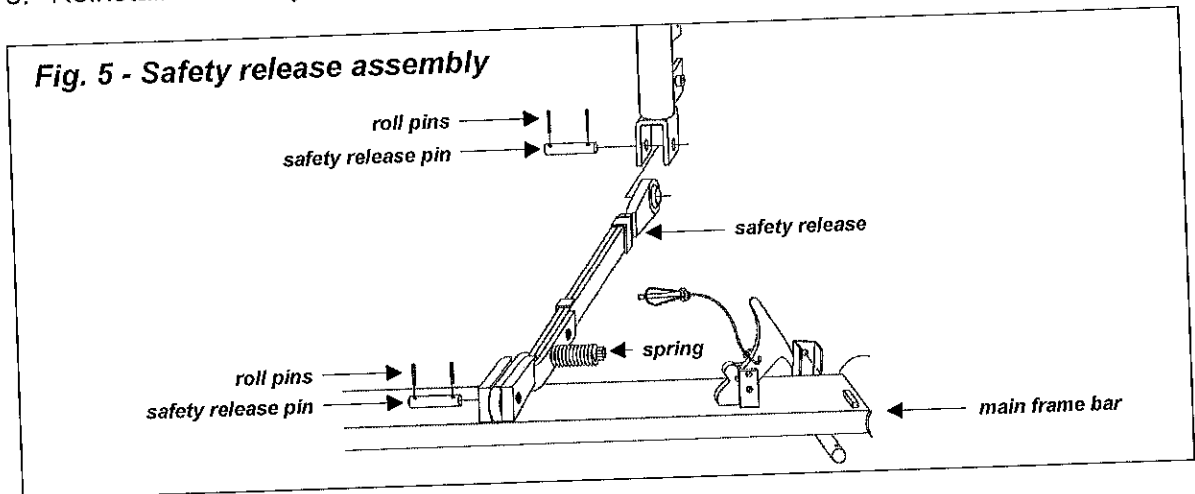

To assemble the hydraulic lift system (see fig. 6):

1. Remove the hex head bolt (M12x65) from the cylinder stop bracket mounted over the cylinder.
2. Insert the cylinder rod between the lift point lever with slotted holes.
3. Lay the cylinder stop bracket over the lift point lever and align the holes.
4. Insert the hex head bolt (M12x65) through the hole on the cylinder stop bracket, the slotted lift point lever and the cylinder rod.
5. Use the elastic stop nut (M12) to tighten making sure to leave enough slack for the cylinder stop bracket to move freely.

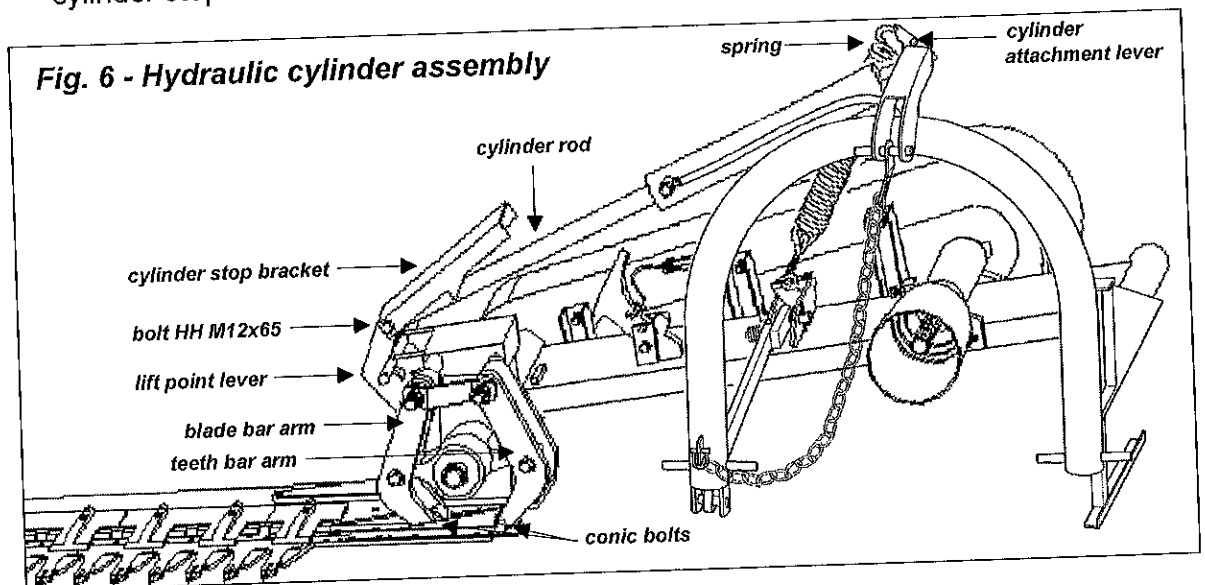

To install the blade and shoe (see fig. 7):

1. Place the black internal skid shoe on the floor.
2. Remove the elastic stop nuts (M14) and let the four bolts (two hex bolts M14x60, one counter sunk bolt M14x60 and one counter sunk bolt M14x70) sit up straight.
3. Position the complete cutting bar assembly over the internal skid shoe and fit the four bolts through the corresponding holes on the blade support bar.
4. Remove the elastic stop nut (M14) from the cutting bar assembly and let the bolt (M14x45) sit up straight.
5. Remove the conic bolts and jam nuts (M12) from the blade section and teeth bar (see fig. 6).
6. Position the sickle bar frame over the complete cutting bar assembly so that the five bolts can be assembled through the support frame.
7. Position the galvanized connector protection with the welded brackets so that the side bracket fits through the counter sunk bolt (M14x70) and the front bracket fits through the carriage bolt (M10x40) mounted on the front of the internal skid shoe.
8. Use the elastic stop nut (M10) to securely tighten the carriage bolt (M10x40) on the front internal skid shoe.
9. Use the five elastic stop nuts (M14) to secure the support frame to the cutting bar assembly.
10. Using the conic bolts, assemble the teeth bar to the teeth bar arm and the blade section to the blade bar arm (see fig. 6). Apply a few drops of thread retainer fluid to the threads of the conic bolts. This will help to prevent failures due to bolts loosening. Using a torque wrench, **tighten conic bolts to 95 ft-lb**. Secure them using the jam nuts (M12).

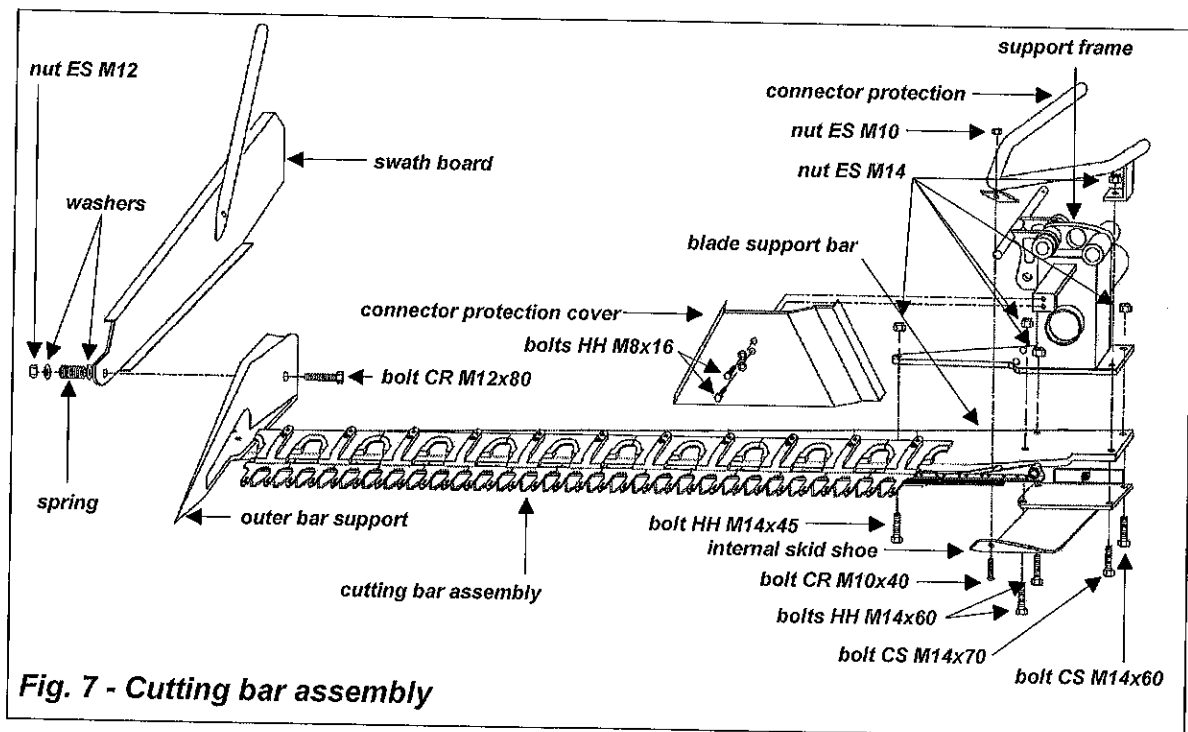

To install the connector protection cover (see fig. 7):

1. Remove the two hex head bolts (M8x16) and the two washers (Ø8x24x2) from the large support frame.
2. Position the connector protection cover making sure to align the holes on the cover to the holes on the support frame.
3. Assemble using the two hex head bolts (M8x16) and the two washers (Ø8x24x2) previously removed and tighten securely.

To install the swath board (see fig. 7):

1. Remove the carriage bolt (M12x80) and spring from the swath board.
2. Position the swath board against the outer bar support.
3. Align the holes and insert the carriage bolt (M12x80) through the hole on the outer support bar and through the hole on the swath board.
4. Insert the first washer (Ø12x24x2.5), the spring and the second washer (Ø12x24x2.5) through the carriage bolt (M12x80).
5. Use the elastic stop nut (M12) to tighten securely.

3.04 - Pre-Operational Check

IMPORTANT: Check each of the following, carefully, prior to engaging the equipment:

1. All lubrication points have been greased.
2. The belts for proper tension.
3. The driveline cross and bearings have been greased.
4. No wrappings or foreign objects are around the cutting bar, belts or driveline.
5. The blades are properly installed.
6. All hardware is tight.
7. The tractor, to ensure correct direction of PTO and rpm speed.
8. All safety shields and guards are in place and tightly attached.
9. No people or animals are in the work area.
10. When working, make sure the tractor hitch is in the "float" position, in order to allow the mower to follow the contour of the ground.



DANGER: Stay clear of rotating driveline. Entanglement in rotating driveline can cause serious injury. Disengage PTO, engage parking brake or place transmission in "Park", shut off the tractor and remove the key before working around hitch, attaching or detaching driveline, making adjustments, servicing or cleaning the machine.

3.05 - Attaching to the Tractor

Model BSB-060 may be used on tractors ranging from 16 to 40 HP equipped with a standard PTO and a limited category 1 or category 1 three point hitch or a category 1 Quick-Hitch.

Models BSB-074, 084, 096, 106 may be used on tractors ranging from 20 to 75 HP equipped with a standard PTO and a category 1 or 2 three point hitch or a category 1 Quick-Hitch⁴. **Never use this mower with tractors over 75 HP.**



CAUTION: Check the tractor PTO rpm to ensure it is set at 400 and turns clockwise.



CAUTION: Always ensure that the tractor tire pressure is correct according to the tractor operator's manual.



DANGER: Failure to ensure a secure coupling of the implement to the tractor can cause injury and damage to the implement or tractor.

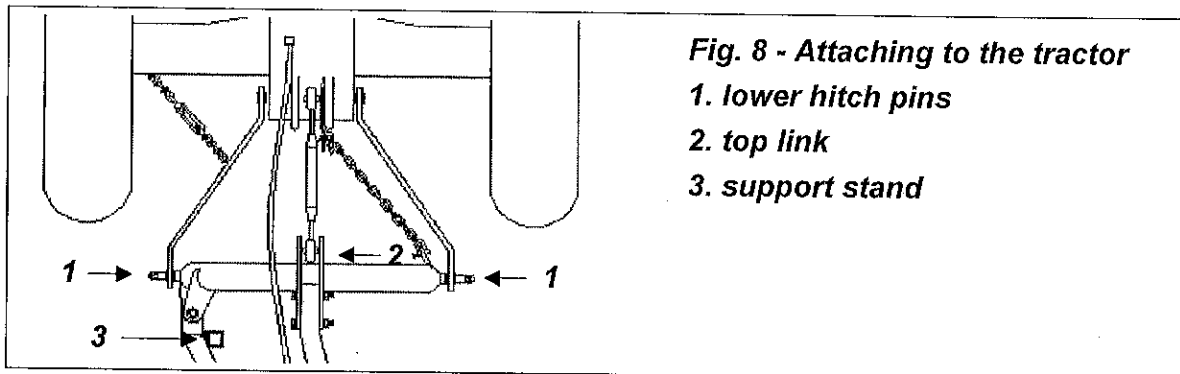

To attach the sickle bar to the tractor do the following:

Remove lower hitch pins and back tractor up to implement. Once in position set parking brake, shut off engine and remove key before dismounting to attach implement. Slide tractor's lower hitch arms between the plates of the lower hitch of the implement. Replace lower hitch pins and secure with lynch pins. Attach top link of the tractor to the top of the "A" frame of the implement. Adjust tractor's stabilizer bars to prevent implement from swinging side to side. Install the driveline and make sure it is locked securely on the tractor's PTO and on the implement prior to engagement. Check that the driveline guard is free to turn and secure it with the two chains. Remove the guard over the cutting blades. Raise sickle bar. Remove the pin that retains the support stand, turn the support stand upside down and reassemble it on the frame securing it with the pin.

IMPORTANT: See Section 4.03 - Driveline, to ensure the driveline is the proper length.

⁴ See Table 2, page 30.

3.06 - Start Up



DANGER: Never stand between the tractor and implement to operate the lifting controls of the tractor from outside of the driver's seat.

Lower mower to the ground with the tractor rock shaft control lever. With the engine idling, slowly engage the PTO drive. Move the throttle lever until the PTO speed indicated on the mower is obtained.

The mower is set for a PTO speed of 400 rpm.

Shift the transmission to a slow speed gear and start forward, increase the ground speed by shifting upward until the desired speed is obtained.



CAUTION: Do not operate this mower at a PTO speed or direction of rotation other than that shown on the mower. Serious damage can occur to the machine and/or the operator.

Before starting to mow, never forget that the **operator is responsible** for the following:

1. Safe and correct driving of the tractor and mower.
2. To learn precise safe operating procedures for both the tractor and the mower.
3. To ensure all maintenance and lubrication has been performed on the mower.
4. To have read and understood all safety aspects for the mower in the operator's manual.
5. To have read and understood all safety decals on the mower.
6. Checking the condition of the blades. Worn or damaged blades should be changed before starting.
7. Checking that there is no wire, weed, grass or other material wrapped around blades.
8. Checking to see if front weights need to be added to the tractor in order to maintain balance.
9. Checking the tractor tires for the proper pressure in accordance with the tractor operator's manual.
10. **Checking that the PTO shield, belt shields and all other shielding are on the machine and securely in place.**
11. Making sure the proper attire is worn. Avoiding loose fitting clothing which can become entangled. Wearing sturdy, tough-soled work shoes and protective equipment for eyes, hands, ears and head. Never operate tractor or implements in bare feet, sandals or sneakers.
12. Checking area for stones, branches and other debris that might be thrown.
13. Ensuring proper lighting is available, sunlight or good artificial lighting.

3.07 - Working Speed

The mowing speed depends on ground conditions, tractor HP, mowing height, and grass thickness. Only a test run will enable you to gauge the optimal working speed for your conditions. Under most conditions a 5 to 6 mph ground speed is best. For a good quality cut it is recommended to keep a steady work speed no slower than 5 mph. This will facilitate grass discharge. Working speed should never exceed 6.5 mph to avoid damage to the unit.

In order to avoid clogging up of blade or if grass is tangled or flattened it is recommended to keep cutting bar grazing the ground.

In order to obtain the best cut possible, always keep the tractor rpm up to the speed indicated on the mower. When increasing or decreasing mowing ground speed, always use gear selection, not engine speed. This will maintain the constant maximum blade speed necessary for a clean cut.

All of the following factors are important in selecting the proper forward speed:

1. Height of grass.
2. Type of grass.
3. Density of grass.
4. Type of terrain.
5. Grass condition, wet or dry.

3.08 - Operating Techniques



DANGER: If blades become jammed it is advisable to operate carefully, wearing adequate personal protection before attempting to free them from obstruction.

Under most working conditions operate PTO at approximately 400 rpm. This is necessary to maintain proper blade speed, obtain a clean cut and reduce the risk of jamming the blades or shearing the conic bolts. Always raise the implement before reversing or changing direction.

Adjusting the sickle bar

To ensure optimum use, the cutting bar of the mower must be able to extend beyond the width of the tractor tires. Our sickle bars (except the BSB-060) can be adapted to fit to your tractor by adjusting the frame shaft and the arm either towards or away from the cutting bar (**see fig. 9**). Assemble the cutting bar away from the three point hitch when mowing with tractors with a wide wheelbase and closer to the three point hitch when mowing with tractors with a narrow wheelbase. Ideally the cutting bar should begin just outside the outer edge of the tire.

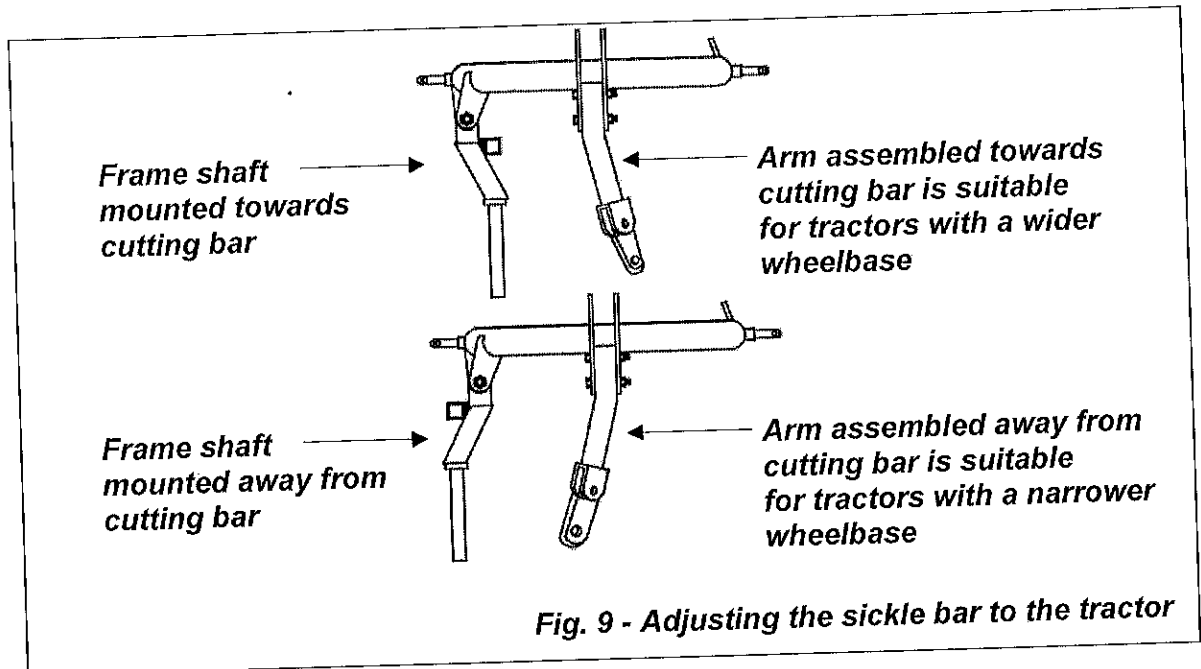

Working Position

Raise the stand, remove safety shield from cutting bar, disengage safety lever (see fig. 11), lower cutting bar, fit the sickle bar by adjusting the tractor stabilizer bars so that when sickle bar is attached to the three points on the tractor, the external tip of the cutting arm is approximately 2" forward with respect to the arm base.

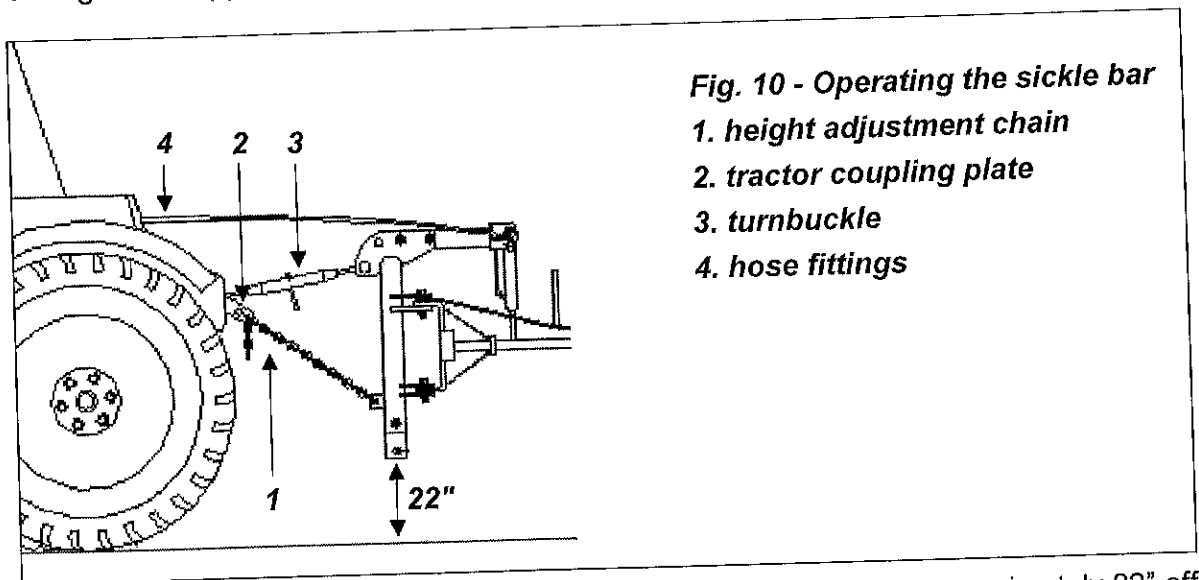

When mowing, the bottom of the three point hitch frame should be approximately 22" off the ground (see fig. 10). Never operate the sickle bar with the three point hitch close to the ground as this could cause damage to the frame and/or the hydraulic cylinder. To set the height of the sickle bar mower use the chain near the lower hitch pin of the mower and attach the appropriate link through the hole on the tractor coupling plate

provided with the mower. It is advisable to mark the link used so that the same position may be used each time the sickle bar is fitted to the tractor (see fig. 10). Level the cutting bar by using the turnbuckle (see fig. 10).

It is possible to adjust the cutting height of the cutting bar from a minimum of 1.2" to a maximum of 2.7" simply by assembling the internal and external skid shoes into one of the other holes provided on the unit.

Operating the sickle bar

During operation make sure to set the tractor hitch in the "float" position so that the weight of the mower is supported by the chain. This will help the mower follow the contour of the ground.

Raising and lowering of cutting bar

Raising and lowering of the cutting bar is performed by a single action hydraulic cylinder, supplied with flow valve adjustments⁵ that require a single remote on the tractor to be able to work.

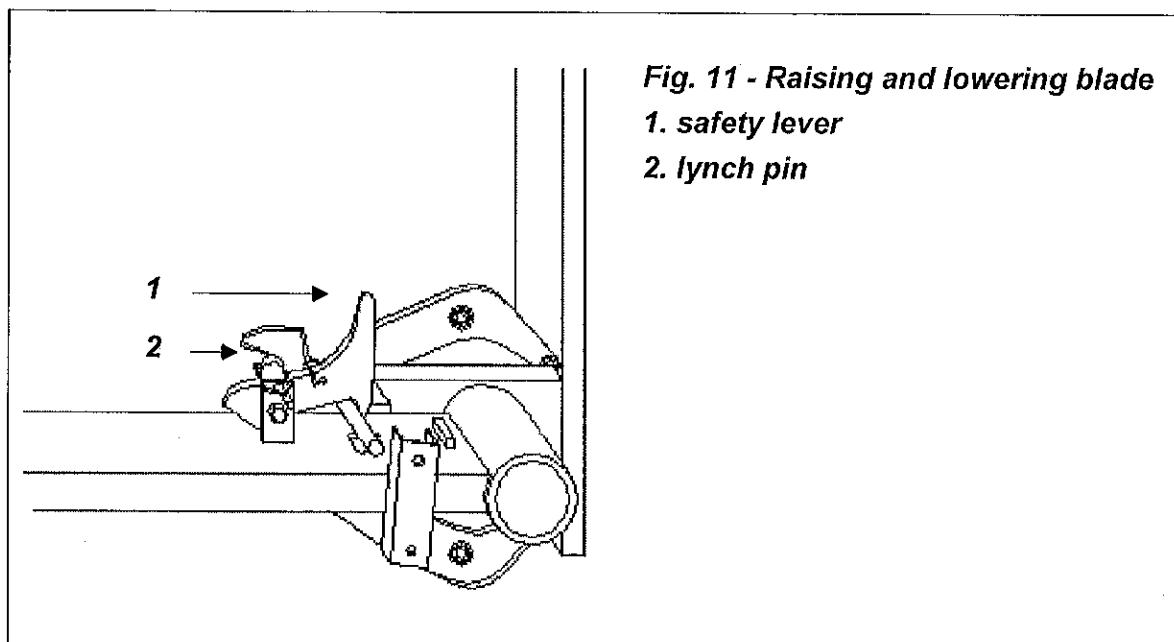

Fig. 11 - Raising and lowering blade

1. safety lever

2. lynch pin

Our sickle bar mowers are equipped with a locking safety lever that the operator engages once cutting bar is raised more than 90 degrees (see fig. 11).

To disengage the lever, the operator must do so manually. Remove lynch pin securing lever, push cutting bar towards main frame to make lever rise, hold lever up and allow cutting bar to disengage.

Cutting bar raise lock

Sickle bar mowers are equipped with a cutting bar raise lock (see fig. 12). This lock allows operator to raise the cutting bar, using the tractor hydraulic remote,

⁵ See Paragraph 3.10 - Hydraulic cylinder flow valve adjustments, for more information on how to operate the flow valves.

SICKLE BAR MOWERS

approximately 12" from the ground and turn around so that end of field maneuvers can be carried out without ever having to raise the three point hitch. Once the tractor is turned around, operator lowers the cutting bar and resumes mowing.

IMPORTANT: To use the cutting bar raise lock mechanism ensure that the cylinder stop is resting along the cylinder (see working position, fig. 12).

Safety release latch

The sickle bar mower is protected with a safety release mechanism (see #2, fig. 13). If the cutter bar is driven into a foreign object such as a tree or a pole, the safety release mechanism will allow the cutter bar to swing back to avoid major damage to the unit. In the event of a collision with a foreign object, immediately stop the tractor, do not raise sickle bar. Turn off tractor engine and make sure the driveline halves have not become separated, if so, reassemble the two halves. To reset safety release, back up tractor until latch returns to its normal position. If the safety release latch breaks away too often adjust the spring using nut bolted at the end and tighten a half turn at a time (see #3, fig. 13).

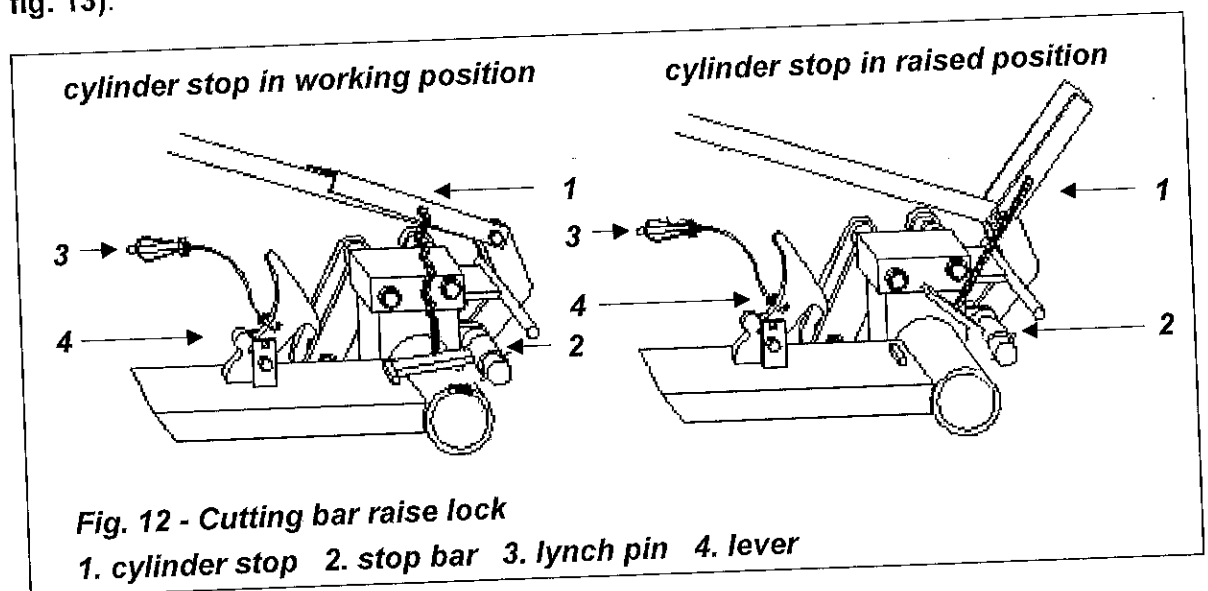

DANGER: The mower blades can throw objects hundreds of feet which could result in personal or property damage. Pick up all rocks and other debris before mowing. Enter new areas carefully. Cut grass higher at first, allowing mower to clear hidden objects.



CAUTION: For emergency reasons learn how to stop the tractor and mower quickly. On the sickle bar mower always disengage the PTO, lock parking brake,

stop engine and allow the blades to come to a complete stop before dismounting the tractor.

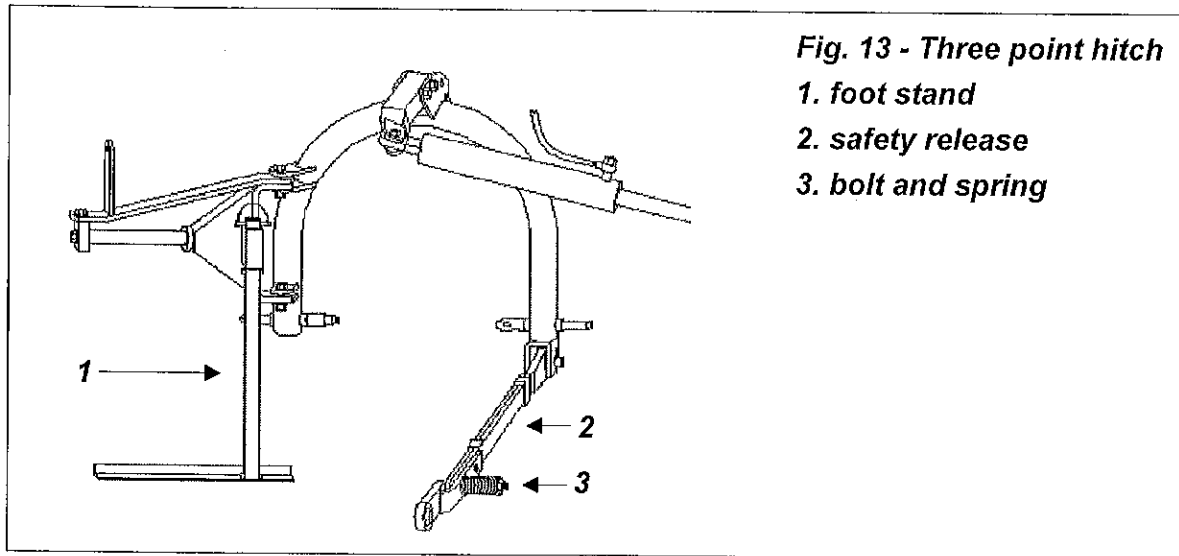

Fig. 13 - Three point hitch
1. foot stand
2. safety release
3. bolt and spring

3.09 - Uneven Terrain



DANGER: Be careful of rollover when operating tractor and implement over uneven ground.

The following precautions should always be observed when working on uneven terrain:

1. In extremely uneven terrain rear wheel weights, front tractor weights, and/or tire ballast should be used to improve stability.
2. Observe the type of terrain and develop a safe working pattern.
3. Whenever traction or stability is doubtful, first test drive over the terrain with the PTO disengaged.
4. Operate the implement up and down steep slopes, not across slopes, to prevent the tractor from tipping. Avoid sudden stops and starts, slow down before changing directions on a slope.
5. Pass diagonally through sharp dips and avoid sharp drops to prevent hanging up the tractor and implement.
6. Slow down on sharp turns and slopes to prevent tipping or loss of control.
7. Watch for holes, roots or other hidden objects. Do not use near the edge of a gully, ditch or stream bank.

NOTE: When mowing over uneven terrain keep cylinder stop in raised position (see fig. 12).

3.10 - Hydraulic cylinder flow valve adjustment

Sickle bar mowers are equipped with a flow regulation valve that allows operator to adjust the speed at which the cutting bar is raised or lowered. To adjust raising and lowering speed of sickle bar mower blade proceed as follows: If blade raises up too fast, from tractor seat turn valve (A) in clockwise direction (see fig. 14). This will gradually reduce oil flow and consequently reduce speed. Adjust until you obtain a slow raising movement. If descend speed of blade is too fast, from tractor seat turn valve (B) (see fig. 14) in a counterclockwise direction. This will gradually reduce oil flow and consequently reduce descending speed. Adjust until you obtain a slow movement.

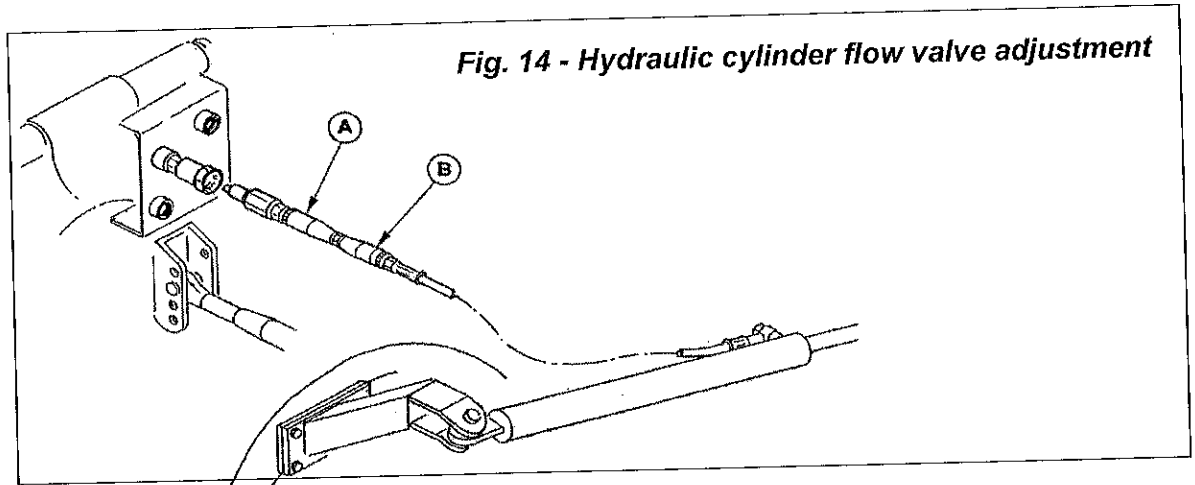

3.11 - Angle of Cut

The sickle bar mower is designed to work on any type of lawn and to work on bank and ditches from 90° up -55° down (-35° down on BSB-060) (see fig. 15).

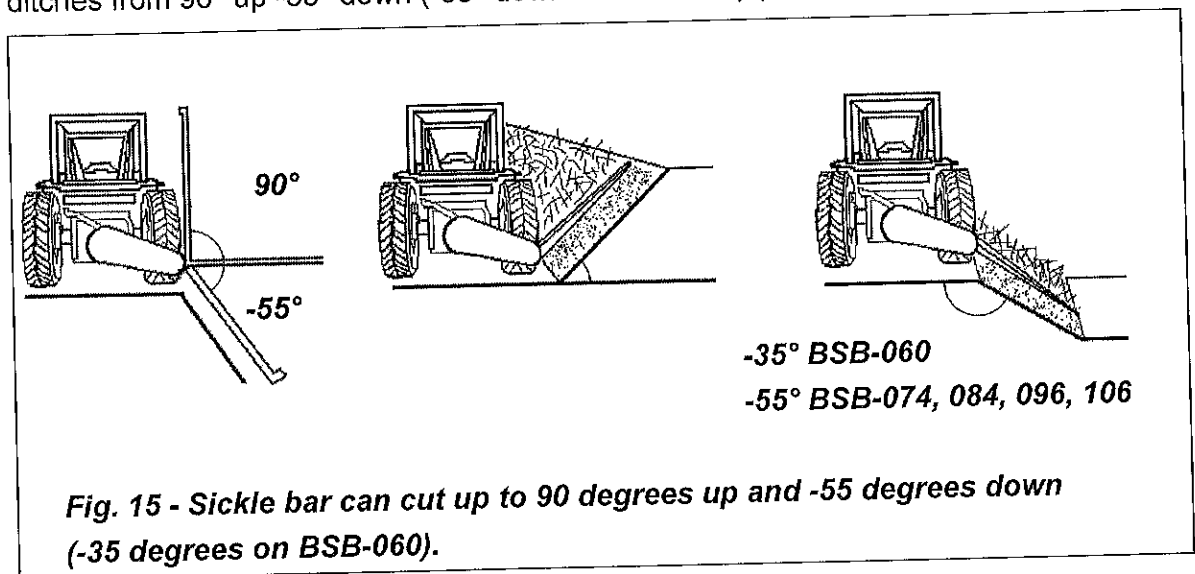

3.12 - Removing Mower from Tractor



DANGER: Avoid injury from blade. Always replace safety shield on cutting bar when mower is not in use.

To remove the mower from the tractor do the following:

1. Set up sickle bar on level and solid ground.
2. Disengage tractor PTO.
3. Set parking brake.
4. Raise the sickle bar.
5. Replace safety shield on cutting bar.
6. Put support stand in position and secure with pin.
7. Lower sickle bar to the ground.
8. Stop engine and remove key from ignition.
9. Disconnect mower driveline from tractor PTO shaft.
10. Disconnect three point linkage and carefully drive tractor away from mower.



CAUTION: Disengage tractor PTO. Set parking brake. Stop engine and remove key from ignition. Disconnect mower driveline from tractor PTO shaft. Collapse driveline and secure it in a safe place. Disconnect three point linkage and carefully drive tractor away from mower.

3.13 - Transport

Before transporting:

Adjust and fix the stabilizer bars of the side lifting arms of the tractor. Lift the cutting bar and engage the safety lever (**see fig. 11**). Replace the safety shield on the cutting bar. Lift implement and place the hydraulic lifting command lever in locked position. Always select a safe ground speed that is appropriate for the terrain. Beware of traffic on public roads. Install a SMV (Slow Moving Vehicle) sign when traveling on roads or streets. Reduce ground speed when turning and take care that the mower does not strike obstacles such as trees, fences or buildings.



CAUTION: Make sure PTO is disengaged and blades have come to a complete stop before raising mower to full transport position. Do not tow tractor and mower behind other vehicles. Use a properly equipped trailer with heavy tie-downs for towing operations.

4 - MAINTENANCE



DANGER: Stop engine, lock parking brake and remove key before performing any service or maintenance.
Never rely on the tractor lift system. Install blocks or stands under the implement to prevent it from falling.
Always use personal protection devices, such as glasses or gloves when performing maintenance.
Keep fingers out of slots to prevent injury.

4.01 - Maintenance Safety



1. Good maintenance is your responsibility.
2. Keep service area clean and dry. Be sure electrical outlets and tools are properly grounded. Use adequate light for the job at hand.
3. Make sure there is plenty of ventilation. Never operate the engine of the towing vehicle in a closed building. The exhaust fumes may cause asphyxiation.
4. Make no repair or adjustments with the tractor engine running. Before working on the machine, disengage the PTO, shut off the engine, set the brakes, and remove the ignition key.
5. Be certain all moving parts on attachment have come to a complete stop before attempting to perform maintenance.
6. Never work under equipment unless it is blocked securely.
7. Always use personal protection devices such as eye, hand and hearing protectors, when performing any service or maintenance.
8. Frequently check mower blades. They should be sharp, free of nicks and cracks and securely fastened.
9. Periodically tighten all bolts, nuts and screws and check that all cotter pins are properly installed to ensure unit is in a safe condition.
10. When completing a maintenance or service function, make sure all safety shields and devices are installed before placing unit in service.
11. Do not attempt to mount a tire unless you have the proper equipment and experience to do the job.
12. Inflating or servicing tires can be dangerous. Whenever possible, trained personnel should be called to service and/or mount tires.
13. After servicing, be sure all tools, parts and service equipment are removed.

14. Never replace hex bolts with less than grade five bolts unless otherwise specified, i.e. shear bolts⁶.
15. Where replacement parts are necessary for periodic maintenance and servicing, genuine replacement parts must be used to restore your equipment to original specifications. The company will not claim responsibility for use of unapproved parts and/or accessories and other damages as a result of their use.
16. Unauthorized modifications to the machine may impair the function and/or safety of the machine and reduce its life. If equipment has been altered in any way from original design, the manufacturer does not accept any liability for injury or warranty.

4.02 - Service

The chart below gives the frequency of lubrication in hours, based on normal operating conditions. Severe or unusual conditions may require more frequent lubrication. Use a good quality SAE multipurpose type grease for all locations shown. Be sure to clean fittings thoroughly before using grease gun.

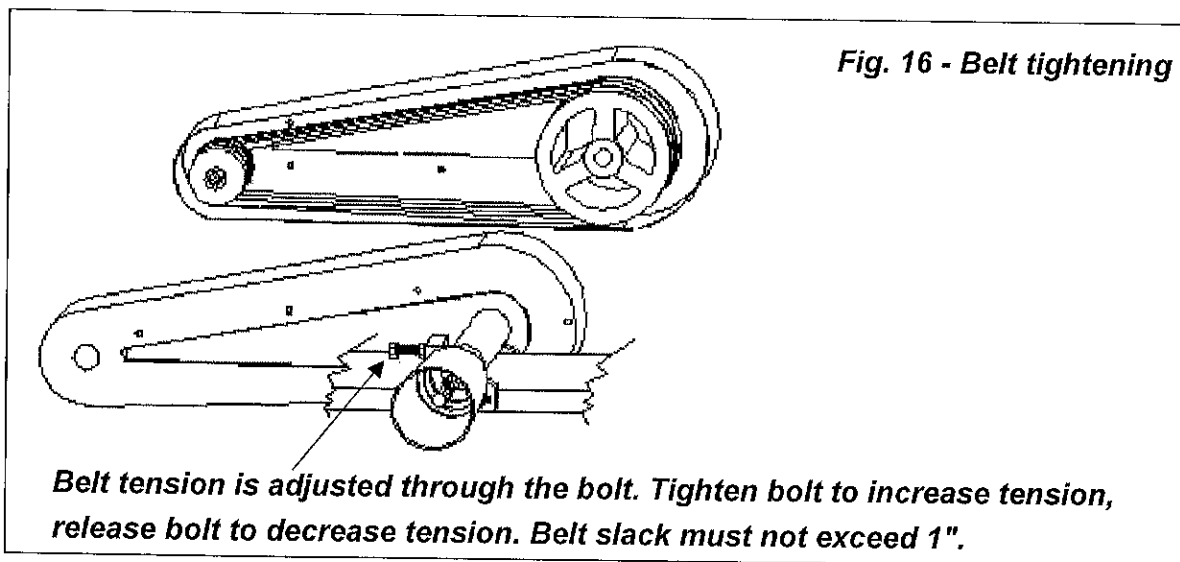

Fig. 16 - Belt tightening

After each mowing job:

Clean and oil the cutting blades.

Every 8 hours:

Grease all points. Grease PTO shaft and all telescoping parts. Adjust belt tension (see fig. 16). Belt slack must not exceed one inch.

Every 25 hours:

Hardware tightness: vibration can loosen bolts. Check tightness of the hardware periodically⁷.

⁶ Refer to Table 1 - Torque Specifications, page 30.

⁷ See Table 1, page 30.

Every 50 hours:

Check the clearance between the cutting blades and the upper blade guide.

4.03 - Driveline

DANGER: Only use the original driveline supplied with this mower and always with the safety shielding. Carefully read and file away the driveline operator's manual supplied by the manufacturer. The following does not substitute the information found in the driveline manual.

IMPORTANT: Always check driveline length during initial setup and when connecting to a different tractor.

In the collapsed position the driveline should be approximately 2" from bottoming out to prevent possible damage to the tractor or implement. When the driveline is in the maximum extended position, the ideal minimum overlap of the two halves should be approximately 6" (see fig. 17).

Fig. 17

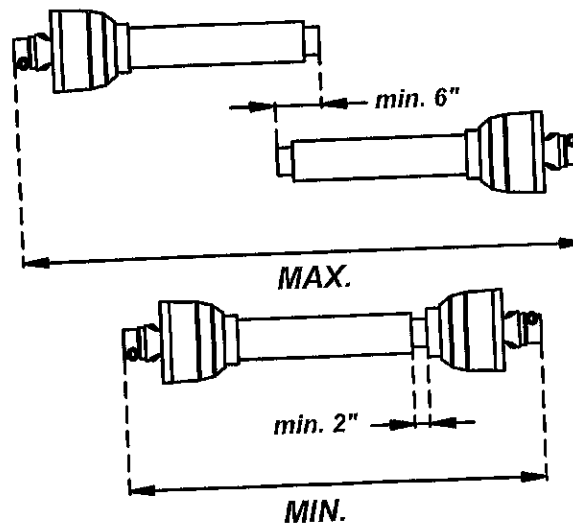

- If determined that the driveline is too long, follow these procedures to adjust the length:
1. Separate the two driveline halves. Connect one half to the tractor PTO and the other half to the mower.
 2. Raise and lower the mower with the 3 point hitch to find the position where the driveline is shortest. Hold the half shafts side by side and mark the desired length on the outer female tube guard leaving a 1½" gap between the end of the guard tube and bell guard.
 3. Cut off both guard tubes the same amount as marked in step 2.
 4. Shorten both drive tubes the same amount as guard tubes.







5. De-burr and clean filings from drive tubes and apply grease to outside of inner telescoping tube.
6. Reassemble the driveline halves and connect to tractor and mower. Raise and lower mower again to be sure driveline does not bottom out in its shortest position and has a minimum overlap of 6" in the longest position.
7. Install both driveline safety chains. One should be hooked in a hole on the outer driveline yoke shield and to the tractor to restrict outer shield rotation. The second one should be hooked in a hole on the inner driveline yoke shield and to the implement to restrict inner shield rotation.

If determined that the driveline is too short for your tractor, contact your local dealer.



CAUTION: Always work with the driveline as straight as possible. This will prolong its life and that of its components. It is advised not to work at an angle greater than 15 degrees.

TABLE 1 - TORQUE SPECIFICATIONS

Metric (ISO) treaded bolts head marking							Inch (SAE) treaded bolts head marking								
	Class 5.8		Class 8.8		Class 10.9			Grade 2		Grade 5		Grade 8			
Bolt size mm	Thread mm	N.m	ft-lb	N.m	ft-lb	N.m	ft-lb	Bolt size inch	Thread inch tpi	N.m	ft-lb	N.m	ft-lb	N.m	ft-lb
M5	0.8	4	3	6	4	9	7	1/4"	20	7	5	11	8	16	12
M6	1	6	4	10	7	15	11	1/4"	28	8	6	13	10	19	14
M8	1.25	16	12	25	18	36	27	5/16"	18	15	11	24	17	33	25
M8	1	17	13	26	19	38	28	5/16"	24	17	13	26	19	37	27
M10	1.5	31	23	48	35	71	52	3/8"	16	27	20	42	31	59	44
M10	1.25	33	24	51	38	75	55	3/8"	24	31	23	47	35	67	49
M10	1	35	26	53	39	78	58	7/16"	14	43	32	67	49	95	70
M12	1.75	54	40	84	62	123	91	7/16"	20	48	36	75	55	106	78
M12	1.5	56	41	87	64	128	94	1/2"	13	66	48	102	75	144	106
M12	1.25	59	44	90	66	133	98	1/2"	20	75	55	115	85	163	120
M14	2	84	62	133	98	195	144	9/16"	12	95	70	147	109	208	154
M14	1.5	94	69	142	105	209	154	9/16"	18	106	79	164	121	232	171
M16	2	131	97	206	152	302	223	5/8"	11	132	97	203	150	287	212
M16	1.5	141	104	218	161	320	236	5/8"	18	149	110	230	170	325	240
M18	2.5	181	133	295	218	421	310	3/4"	10	233	172	361	266	509	376
M18	2	196	145	311	229	443	327	3/4"	16	261	192	403	297	569	420
M18	1.5	203	150	327	241	465	343	7/8"	9	226	167	582	430	822	606
M20	2.5	256	189	415	306	592	437	7/8"	14	249	184	642	473	906	668
M20	1.5	288	212	454	335	646	476	1"	8	339	250	873	644	1232	909
M22	2.5	344	254	567	418	807	595	1"	12	371	273	955	704	1348	995
M22	1.5	381	281	613	452	873	644	1-1/8"	7	480	354	1077	794	1746	1288
M24	3	444	327	714	526	1017	750	1-1/8"	12	539	397	1208	891	1958	1445
M24	2	488	360	769	567	1095	808	1-1/4"	7	677	500	1519	1120	2463	1817
M27	3	656	484	1050	774	1496	1103	1-1/4"	12	750	553	1682	1241	2728	2012
M27	2	719	530	1119	825	1594	1176	1-3/8"	6	888	655	1992	1469	3230	2382
M30	3.5	906	668	1420	1047	2033	1499	1-3/8"	12	1011	746	2268	1673	3677	2712
M30	2	1000	738	1600	1180	2250	1659	1-1/2"	6	1179	869	2643	1949	4286	3161
M36	4	1534	1131	2482	1830	3535	2607	1-1/2"	12	1326	978	2974	2194	4823	3557

When using lock washers with nuts, increase torque values by 5%.

TABLE 2 - SICKLE BAR MOWERS - TECHNICAL FEATURES

Series BSB sickle bar mowers, for tractors up to 75 HP.								
Model	HP	Working width	Weight lb.	Lift	Max. working speed	PTO (rpm)	3 point hitch	Driveline 1 3/8"
BSB-060	16-40	60"	485	Hydraulic	6.5 mph	400	Limited cat. 1 & cat. 1	ASAE cat. 2
BSB-074	20-75	75"	518	Hydraulic	6.5 mph	400	Cat. 1 & 2	ASAE cat. 3
BSB-084	20-75	83"	540	Hydraulic	6.5 mph	400	Cat. 1 & 2	ASAE cat. 3
BSB-096	20-75	95"	595	Hydraulic	6.5 mph	400	Cat. 1 & 2	ASAE cat. 3
BSB-106	20-75	106"	655	Hydraulic	6.5 mph	400	Cat. 1 & 2	ASAE cat. 3

5 - REPAIR PROCEDURES



CAUTION: All repair procedures must be done by authorized dealerships. It is not recommended that untrained individuals perform any repair work.

5.01 - Blade Replacement

Replacement of blade section

With the implement resting on the ground lower the cutting bar so that it is laying flat on the ground. Remove the three hex flanged bolts (M8x16) and nuts (M8) from the section head and pull out the blade section from the outside of the cutting bar by inserting a metal hook through the hole on the furthestmost blade (see fig. 18). Reassemble the new blade section and assemble it to the section head using the three bolts (M8x16) and nuts. If necessary, lubricate the blade section to facilitate removal and replacement work.

Move blade section and teeth bar back and forth to make sure both slide well in the blade guide. It is important for the blade section and teeth bar to slide easily and with no obstructions inside the blade guide.

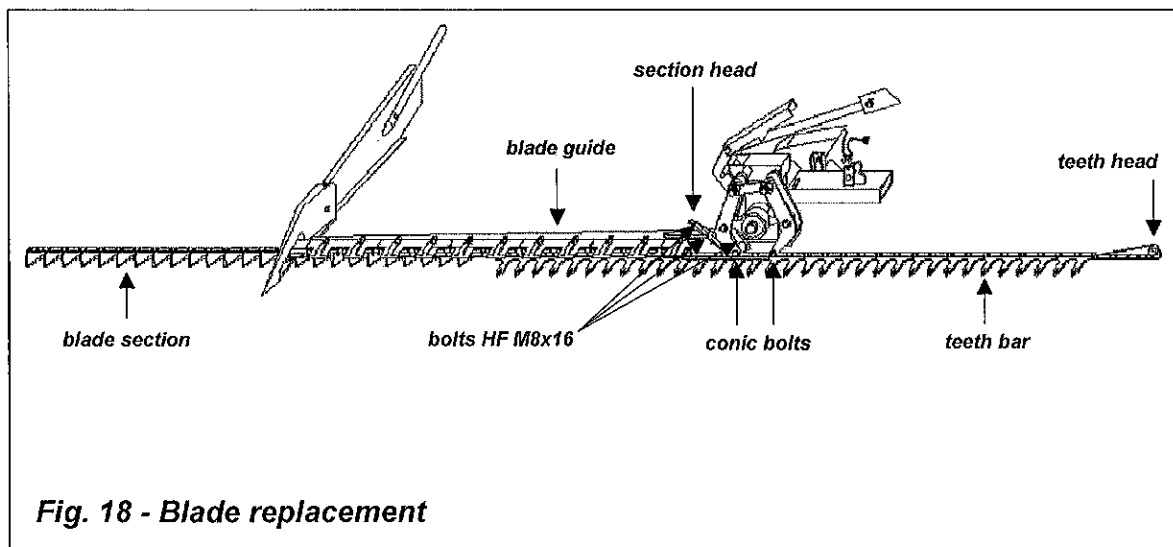

Replacement of individual blade

With the implement resting on the ground lower the cutting bar so that it is laying flat on the ground. Remove the three hex flanged bolts (M8x16) and nuts (M8) from the section head and pull out the blade section from the outside of the cutting bar by inserting a metal hook through the hole on the furthestmost blade (see fig. 18). Remove the rivets

of the damaged blade using a pin punch. Rivet on a new blade making sure rivets are assembled flush with the rod section. Once the new blade is riveted on the rod section reassemble the blade section and assemble it to the section head using the three bolts (M8x16) and nuts (M8). If necessary, lubricate the blade section to facilitate removal and replacement work.

Replacement of teeth bar

With the implement resting on the ground lower the cutting bar so that it is laying flat on the ground. Remove the conic bolt (see fig. 18) and pull out the teeth bar by inserting a metal hook through the teeth head. Insert the new teeth bar and lock in place with the conic bolt. **Torque conic bolts to 95 ft-lb.** If necessary, lubricate the teeth bar to help removal and replacement work.

Checking blade clearance

Every 50 hours or whenever the blade section or teeth bar is replaced the clearance between the teeth bar and blade guide must be checked. Always try to keep approximately 1 mm. clearance between the teeth bar and the blade guide (see fig. 19). Too much clearance can cause material to become entangled with the cutting blade leading to possible failure of parts or poor cutting quality. Too little clearance will cause excessive friction on the blades causing possible failures to the cutting bar.

Adjusting the clearance between the blade guide and the teeth bar is done by simply tightening or loosening the set screws that are located on the blade guide (see fig. 19). After adjusting the clearance check the hex head nut (M10) in front of each set screw to make sure it is adequately tightened.

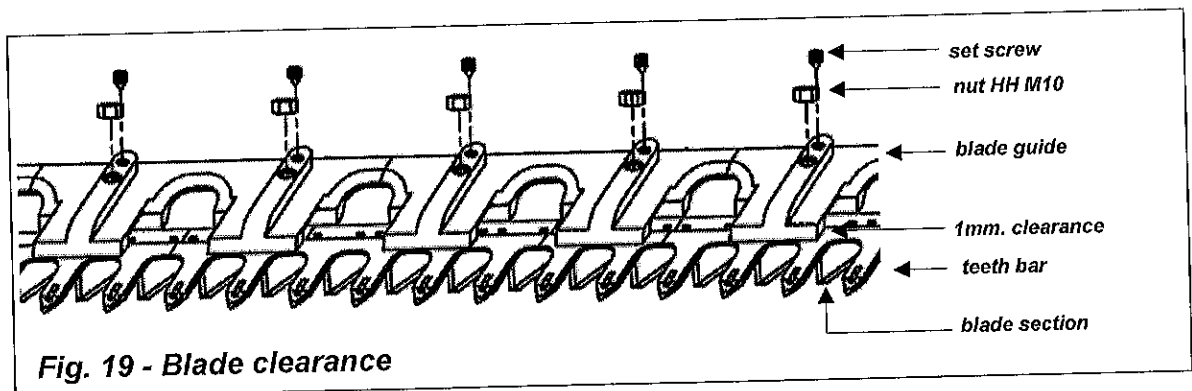

DANGER: Avoid injury from blade. Always replace safety shield on cutting bar when mower is not in use.

5.02 - Suggested Spare Parts

It is suggested that the following spare parts be kept on hand for the implement at all times to prevent a minor problem from delaying work.

Description	Quantity
Complete blade section	1
Conic bolt	2

5.03 - Storage

After seasonal use it is important to perform the following for prolonged storage:

1. When placing machine in storage, lower the support stand and secure it with the lock pin before lowering the unit to the ground.
2. Wash the implement carefully.
3. Inspect the implement and replace worn or damaged parts.
4. Replace safety shield on cutting bar.
5. Tighten all hardware.
6. Grease all areas indicated under Maintenance⁸.
7. Touch up scratches by sanding the area and applying a light coat of primer and paint to prevent rust from forming.
8. Cover the implement from the elements in order to have it in perfect condition for the start of the next season.
9. Make sure all parked machines are on a hard, level surface, and engage all safety devices.
10. Do not permit children to play on or around the stored unit.

Touch up paint available:	
Part #	Description
7300007	Primer, gray - aerosol spray can
7300008	Paint, Befco orange - aerosol spray can
7300010	Paint, Befco black - aerosol spray can



WARNING: Be sure to store the implement on a hard level surface and away from people especially children.

Note: The machine demolition operations should be carried out in compliance with all federal, state and local environment protection laws.

⁸ See Chapter 4 - Maintenance.

6 - TROUBLESHOOTING



WARNING: Be sure tractor engine is off, parking brake is locked, and key is removed before making any adjustments.

PROBLEM	POSSIBLE CAUSE	SOLUTION
Material becomes entangled on the bar.	Too much clearance between cutting blade teeth and upper blade guide.	Check to make sure there is no more than 1 mm. clearance between blade teeth and upper blade guide.
Teeth bar or blade section often fails.	Too little clearance between blade teeth and upper blade guide can create excessive sliding friction on the blade that may result in failures.	Check to make sure there is at least 1 mm. clearance between blade teeth and upper blade guide.
Conic bolts on cutting bar come loose.	Bolts not properly torqued.	Torque conic bolts to 95 ft-lb.
	Lack of thread retainer fluid on threads of conic bolts.	Apply a few drops of thread retainer fluid to the threads of the conic bolts.
Conic bolts on cutting bar shear.	Bolts not properly torqued. Loose belts cause blade teeth to jam and conic bolt to fail.	Torque conic bolts to 95 ft-lb. Tighten belts so there is less than 1" slack.
	PTO speed set too high.	Reduce PTO speed to 400 rpm.

7 - PRE-DELIVERY CHECKLIST

To the dealer: Inspect the machine thoroughly after assembly to assure it is functioning properly before delivering it to the customer. The following checklist is a reminder of points to cover. Check off each item as it is found satisfactory or after proper adjustment is made.

- Guards and shield properly fastened.
- Lubrication of grease fittings.
- All hardware properly tightened.
- Belts are properly tightened.
- All decals properly located and readable (**see fig. 2**).
- Blade section and teeth bar properly installed.
- Overall condition (touch up scratches, clean and polish).
- Test run, check for excessive vibration or overheating of bearings.
- Operator's Manual.

Review the Operator's Manual with the customer. Explain the following:

- Warranty.
- Safe operation and service.
- Correct machine installation and operation.
- Daily and periodic lubrication, maintenance and inspections.
- Troubleshooting.
- Operational procedures and storage.
- Parts and service.
- Fill out the Pre-Delivery Checklist and Warranty Registration form.
- Give customer the Operator's Manual and encourage the customer to read the manual carefully.

IMPORTANT: Warranty is not valid unless Pre-Delivery Checklist and Warranty Registration Form in operator's manual is completed in detail and mailed to the Company.

Model Number: _____

Serial Number: _____

Delivery Date: _____

Dealer's Signature: _____

8 - WARRANTY

BEFCO's responsibility will be limited to substitution of the acknowledged defective merchandise to the same place of delivery as the previous one was supplied.

1. LIMITED WARRANTY

BEFCO, Inc. herein referred to as the Company, warrants its machines and related accessories, hereafter referred to as the Machine, to be free from defects in material and workmanship, for a period of twelve (12) months from the date of invoice to the first registered owner; this limited warranty does not apply to common wear items and excludes belts, shear pins, oil, grease, tires, tubes, hydraulic hoses, knives and PTO shafts.

Labor will be reimbursed at \$40.00 per hour based on BEFCO's time schedule.

Cost of transport to the servicing dealer is the responsibility of the customer.

Warranty coverage shall not be transferable from the first owner to any subsequent owner.

2. DISCLAIMER OF ALL OTHER WARRANTIES AND REMEDIES

Neither the Company nor any company affiliated with the Company makes any warranties, representations or promises, expressed or implied, as to the quality, performance or application of its products other than those set forth herein and does not make any implied warranty of merchantability or fitness.

The only remedies the purchaser has in connection with the breach, or performance of any warranty on the Company's Machine are those set forth herein. In no event will the dealer, the Company, or any company affiliated with the Company, be liable for:

- a. Injuries or damages of any kind or nature, direct, consequential or contingent to person or property.
- b. Any expenses incurred by the owner to repair, replace or rework any allegedly defective item.
- c. Any loss, cost, forfeiture or damages (including loss of profits; loss of crops; loss because of delay in field operations; any expenses or loss incurred for labor, supplies, substitute machine rental; liabilities of the owner to its customers or third persons; and all other consequential damages, losses, liabilities or damages for any other reasons) whether direct or indirect, and whether or not resulting from or contributed to by the default or negligence of the Company, its agents, employees and subcontractors which might be claimed as a result of the use or failure of the equipment delivered.

The Company's liability based on this limited warranty or any other applicable laws shall be limited to replacement or refund of the purchase price of the product.

The limited warranty extended herein gives you specific rights and you may also have other rights which vary from state to state. Neither the dealer nor the Company personnel has the authority to make any representation or to modify the terms and limitations of this warranty in any way.

Other than the limited warranty extended hereby there is no other expressed warranty in connection with the design, safety or use of any of the Company's products except as to title. All implied warranties are expressly disclaimed pursuant to the terms of this warranty.

3. CUSTOM WORK

If the Machine is used for commercial purposes such as custom work, the period warranted for the Machine is limited to six (6) months from the date of delivery to the first registered owner and does not cover any labor charges incurred.

4. RENTAL

If the Machine is used for rental purposes the period warranted for the Machine is limited to thirty (30) days from the date of delivery to the first registered owner and does not cover any labor charges incurred.

5. REGISTRATION

In order to qualify for coverage on this limited warranty, the product and name of the original purchaser must be registered with the Company by a completed Machine Pre-Delivery Checklist and Warranty Registration along with a copy of the dealer's invoice to the first registered owner to the Company within fourteen (14) days after the date of delivery to the original purchaser.

6. WARRANTY SERVICE

Warranty Service must be performed by a dealer authorized by BEFCO. If the warranty service requested is approved, the owner shall pay only for labor beyond the rate allowed, for overtime labor, and for any mileage charge for transporting the equipment to and from the dealer's shop. It is assumed that the dealer has the appropriate general and special tools to service the machine. Time required for replacement of knives, oil, grease and to remove excessive dirt from the Machine is not subject to reimbursement by the Company. The owner is required to clean the Machine before presenting it to the dealer for service work. The Machine must be delivered within thirty (30) days after failure date by the owner to the dealer to be eligible for warranty consideration.

7. UNAPPROVED SERVICE OR MODIFICATION

All obligations of the Company under this limited warranty shall be terminated if:

- a. Proper service and operation instructions as outlined in the Operator's Manual and on the instruction sticker on the Machine, are not followed.
- b. The Machine is modified or altered in any way not approved by the Company.
- c. The Company does not receive a copy of the dealer's invoice to the first registered owner within fourteen (14) days from the date of delivery.
- d. The Company has not been paid in full, by the dealer, for the Machine.

8. ACCIDENTS AND NORMAL MAINTENANCE

This limited warranty covers defective material and workmanship. It does not cover depreciation or damage caused by normal wear, accidents, improper maintenance, improper protection or improper use. The costs of normal maintenance or repairs for accidents or improper use, and related labor will be borne by the owner.

9. REPLACEMENT PARTS

BEFCO, Inc. warrants replacement parts to be free from defect in material and workmanship for a period of thirty (30) days from the date of delivery to the original purchaser.

WARRANTY REGISTRATION

BEFCO, Inc.
 P.O. Box 6036
 Rocky Mount, NC 27802-6036

Tel: (252) 977.9920 - Fax: (252) 977.9718

Dealer	Acct. #	Retail Customer
Street	Country	Street
Town	State Zip	Town State Zip
Date of delivery	Invoice #	Phone
Model #	Serial #	
Pre-Delivery Checklist: <input type="checkbox"/> Greased fittings. <input type="checkbox"/> Safety guards in place. <input type="checkbox"/> All hardware tight. <input type="checkbox"/> Bolts torqued correctly. <input type="checkbox"/> Attached unit to tractor. Yes/No. <input type="checkbox"/> Field adjusted. Yes/No. <input type="checkbox"/> Test run. Dry/Infield. <input type="checkbox"/> Safety decals. <input type="checkbox"/> Operator's Manual.		Tractor make: _____ Model: _____; HP _____ Type of operation: Private homeowner, Landscaping, Commercial maintenance, Golf Course, Municipality, Turf Farm, others: _____ Approximate number of acres machine will be used on annually: _____ I hereby acknowledge that: I have received and accepted delivery of the machine described. The equipment was checked thoroughly for loose or missing parts and has been adjusted in accordance with the Pre-Delivery Checklist. I have read and understand the nature and extent of the warranty and understand clearly that there were and are no other representations of warranties either expressed or implied, made by anyone. I have been advised on proper operation, maintenance and lubrication procedure of this equipment. I have been instructed on and do understand the application, limitation and capacities this equipment was designed and recommended for, all as described in the Operator's Manual and literature published by the Company.
The machine described above has been prepared for delivery according to the Pre-Delivery Checklist and the Customer has been instructed in its care and operation and the condition of warranty.		
Inspected by: _____		
Date: _____		Date: _____
Dealer's Signature: _____		Customer's Signature: _____

This registration along with a copy of the invoice must be sent to BEFCO, Inc. within 14 days of date of purchase.

BEFCO®

Parts Manual

SICKLE BAR MOWERS

BSB-060, BSB-074, BSB-084, BSB-096, BSB-106

(serial #289769 & above)

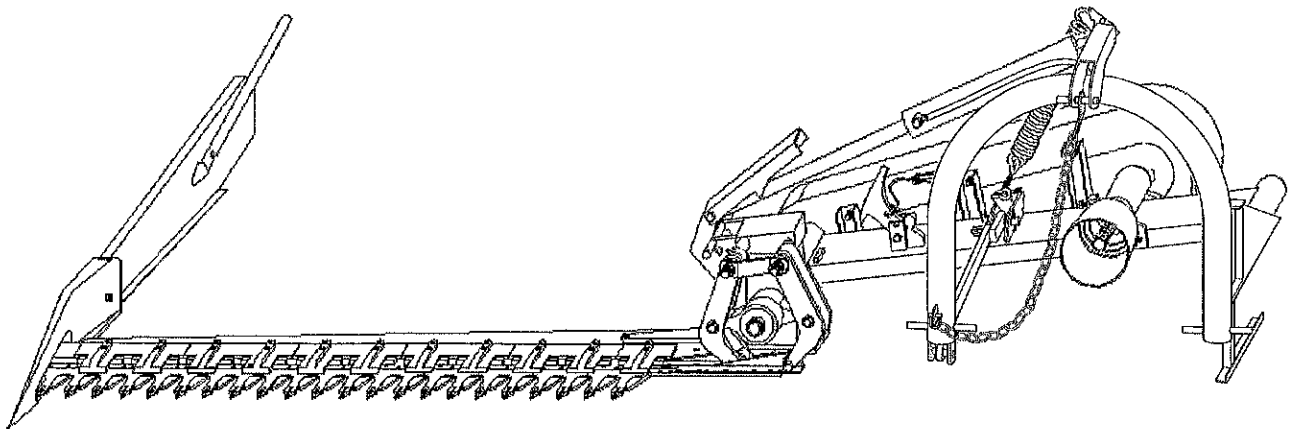

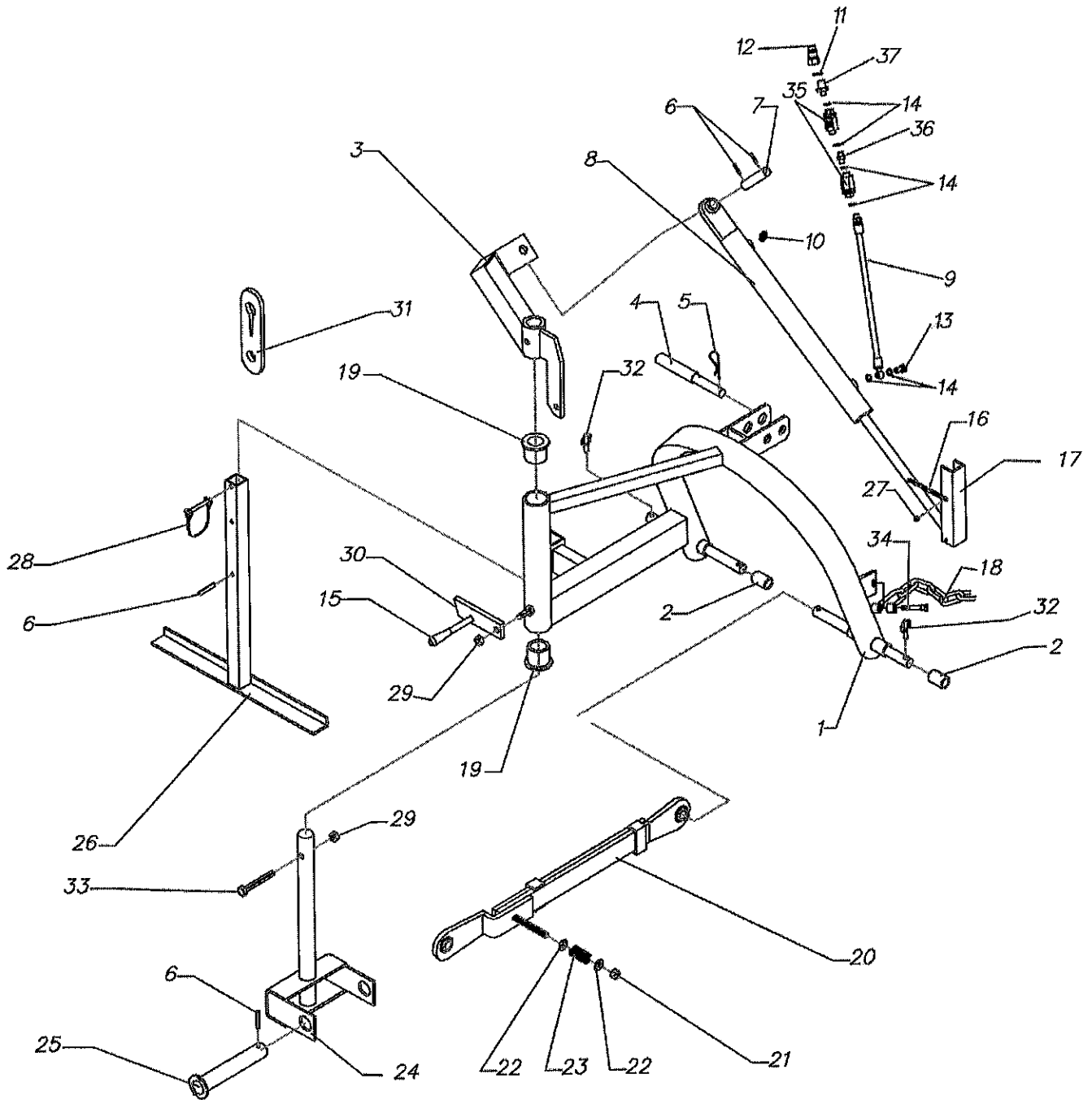

Ref.	Part #	Description	Qty.
1	N00-2675	Three point hitch arch; BSB-060	1
2	N00-C2085	Tractor pin bushing (option)	2
3	N00-2680	Cylinder connection	1
4	N00-C2086	Three point hitch pin 19-25	1
5	009-1507	Hairpin cotter Ø4 Z	1
6	502-625B	Roll pin Ø6x50	5
7	N00-2075	Tractor hitch pin	1
8	N00-2069	Cylinder; BSB-060 #289769 & above	1
9	N00-C2148	Hydraulic hose 1/4"x2000; #289769 & above	1
10	007-9341	Breather cap 1/4"	1
11	003-6532	Washer copper 1/2"	2
12	004-1871	Quick coupler 1/2"	2
13	N00-C1046	Bolt hollow 1/4"x1.00 Z	2
14	005-2438	Washer copper 1/4"	4
15	N00-C1078	Knob Ø12	1
16	N00-C2097	Small chain (18 chain links)	1
17	N00-2083	Cylinder stop w/bolt M6x25 & nut; BSB-060 #289769 & above	1
18	N00-C2094	Chain (20 chain links)	1
19	N00-2685	Frame shaft bushing	2
20	N00-2065	Safety release	1
21	000-7224	Nut ES M14-2.00 Z TK	1
22	N00-2067	Washer lock SP Ø14	2
23	N00-2063	Release spring; BSB-060	1
24	N00-2690	Frame shaft	1
25	N00-2695	Frame shaft pin	1
26	N00-2700	Support stand; BSB-060	1
27	005-0165	Nut ES M06-1.00 Z TK	1
28	N00-C2082	Pin Ø8	1
29	001-3345	Nut ES M12-1.75 Z TK	2
30	N00-2705	Three point stop plate	1
31	N00-2087	Tractor hitch plate	1
32	001-8266	Lynch pin Ø10	2
33	003-4265	Bolt HH M12-1.75x65 C8.8 Z P	1
34	N00-C2080	Shackle M12	1
35	N00-C1866	Flow regulation valve 1/4"; #289769 & above	2
36	008-2484	Adapter 1/4" - 1/4"	1
37	008-2488	Adapter 1/4" - 1/2"	1

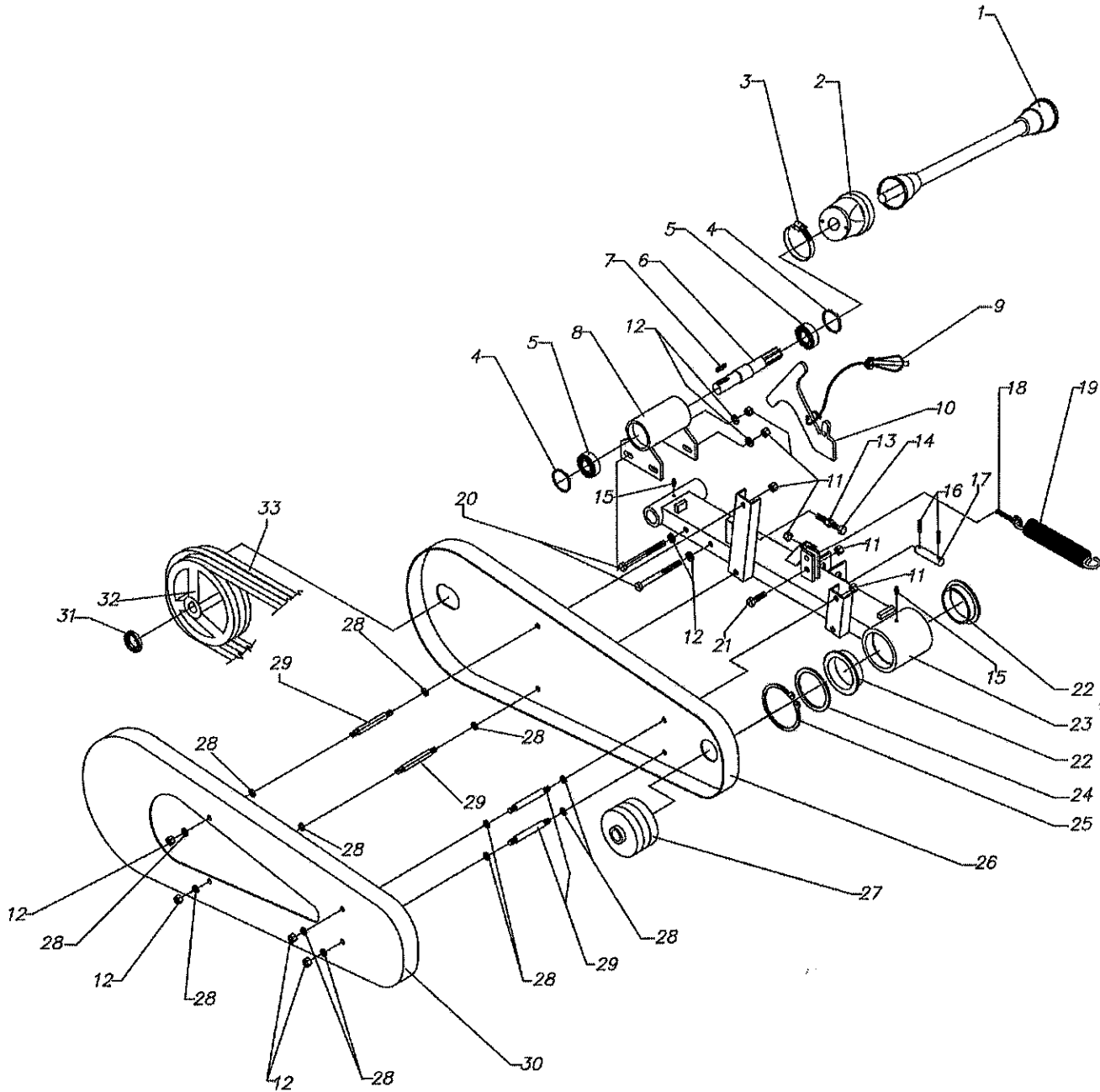

Ref.	Part #	Description	Qty.
1	N00-C2596	Driveline B2x800E	1
2	N00-C2090	Cone	1
3	N00-C2089	Cone ring	1
4	002-5329	Snap ring, inner Ø72	2
5	503-197B	Bearing 6207 2RS	2
6	N00-2505	Shaft	1
7	N00-C2093	Key Ø8x60	1
8	N00-2510	Pulley - Shaft support (support only)	1
9	N00-C2088	Lynch pin Ø10 with chain	1
10	N00-2555	Lever	1
11	001-3345	Nut ES M12-1.75 Z TK	11
12	000-2265	Washer flat Ø12 W	4
13	001-7223	Nut HH M12-1.75 C6 Z TN	1
14	000-7128	Bolt HH M12-1.75x80 C8.8 Z F	1
15	005-1129	Grease fitting M6-1.00	2
16	502-625B	Roll pin Ø6x50	2
17	N00-2060	Safety release pin	1
18	N00-C2091	Eye bolt M12x120	1
19	N00-2500	Spring	1
20	N00-C1026	Bolt HH M12-1.75x135 C8.8 Z P	2
21	000-7716	Bolt HH M12-1.75x45 C8.8 Z F	1
22	N00-2520	Main frame attachment bushing	2
23	N00-2796	Main frame bar; BSB-060	1
24	N00-2580	Main frame attachment washer	1
25	N00-C2203	Snap ring, outer Ø90	1
26	N00-2800	Internal cover; BSB-060	1
27	N00-2535	Pulley SPB 130x2	1
28	007-6106	Washer fender Ø12 Z	12
29	N00-2560	Joint pin	4
30	N00-2805	External cover; BSB-060	1
31	003-0095	Locking ring ES GUK M30-1.50	1
32	N00-2530	Pulley SPB 300x2	1
33	N00-2810	Belt SPB 2000	2
	N00-2640	Complete shaft and support assembly	-
	950-213B	Decal "DANGER - Replace shields"	1
	950-109B	Decal "DANGER - Avoid injury from PTO"	1
	950-955B	Decal "DANGER - Sharp blades"	1
	950-407B	Decal "WARNING - Crushing and pinching hazard"	1
	950-408B	Decal "WARNING - High pressure hydraulic oil leaks"	1
	950-111B	Decal "CAUTION - Read Operator's Manual"	1
	950-463B	Decal "DANGER - Rotating driveline, keep away" outer shield	1
	950-464B	Decal "DANGER - Guard missing, do not operate" outer tube	1
	950-940B	Decal "Quick hitch compatible"	1
	950-103B	Decal "B"	1
	950-106B	Decal "BEFCO"	1
	950-308B	Decal "BSB"	1
	950-284B	Decal "060"	1
	950-381B	Decal "BEFCO INC" address	1
	960-391B	Operator's & Parts Manual "Sickle bar BSB-060, 074, 084, 096, 106 #289769 & above"	1

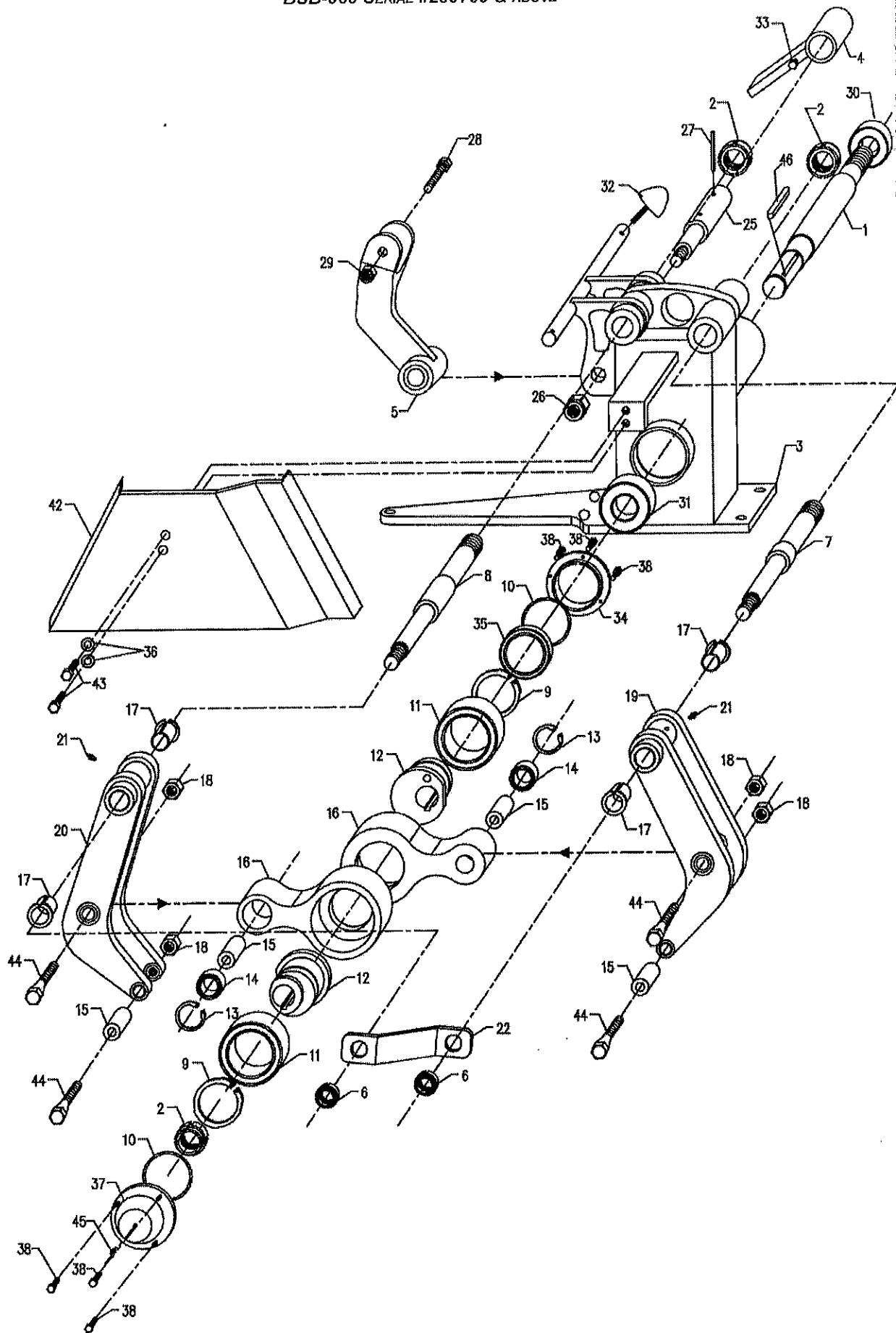

Ref.	Part #	Description	Qty.
1	N00-1000	Shaft	1
2	003-0095	Locking ring ES GUK M30-1.50	3
3	N00-1035	Support	1
4	N00-2570	Stop .	1
5	N00-1063	Lift point lever; #289769 & above	1
6	N00-C2101	Locking ring ES GUK M20-1.00	2
7	N00-1050	Teeth bar arm shaft	1
8	N00-1025	Blade bar arm shaft	1
9	3120134	Snap ring, outer Ø65	2
10	N00-C2201	O-ring 2375	2
11	N00-C2250	Bearing 6013 Z	2
12	N00-1005	Hinge eccentric	2
13	005-0144	Snap ring, inner Ø47	2
14	N00-C2251	Bearing 3204 2RS	2
15	N00-1540	Bushing	4
16	N00-1010	Internal connector	2
17	N00-1045	Bushing	4
18	001-7223	Nut HH M12-1.75 C6 Z TN	4
19	N00-1020	Teeth bar arm	1
20	N00-1015	Blade bar arm	1
21	005-1129	Grease fitting M06-1.00	2
22	N00-1055	Support plate	1
25	N00-1065	Lever lift pin	1
26	002-6314	Nut ES M16-2.00 Z TK	1
27	502-625B	Roll pin Ø6x50	1
28	003-4265	Bolt HH M12-1.75x65 C8.8 Z P	1
29	001-3345	Nut ES M12-1.75 Z TK	1
30	005-0212	Bearing 6306 2RS	1
31	503-197B	Bearing 6207 2RS	1
32	N00-C1080	Stop-block M8	1
33	502-720B	Bolt HH M06-1.00x25 C8.8 Z F	1
34	N00-1087	Oil seal ring	1
35	000-7805	Oil seal 65-85-10	1
36	001-4514	Washer fender Ø8 Z	2
37	N00-1100	Cone	1
38	003-6319	Bolt HH M06-1.00x16 C8.8 Z F	6
42	N00-1123	Connector protection cover	1
43	004-6454	Bolt HH M08-1.25x16 C8.8 Z F	2
44	N00-2098	Conic bolt M12-1.75x65 Z P	4
45	005-3155	Grease fitting 90° M06-1.00	1
46	N00-C2095	Key 8x70	1
	N00-1135	Complete connectors	-

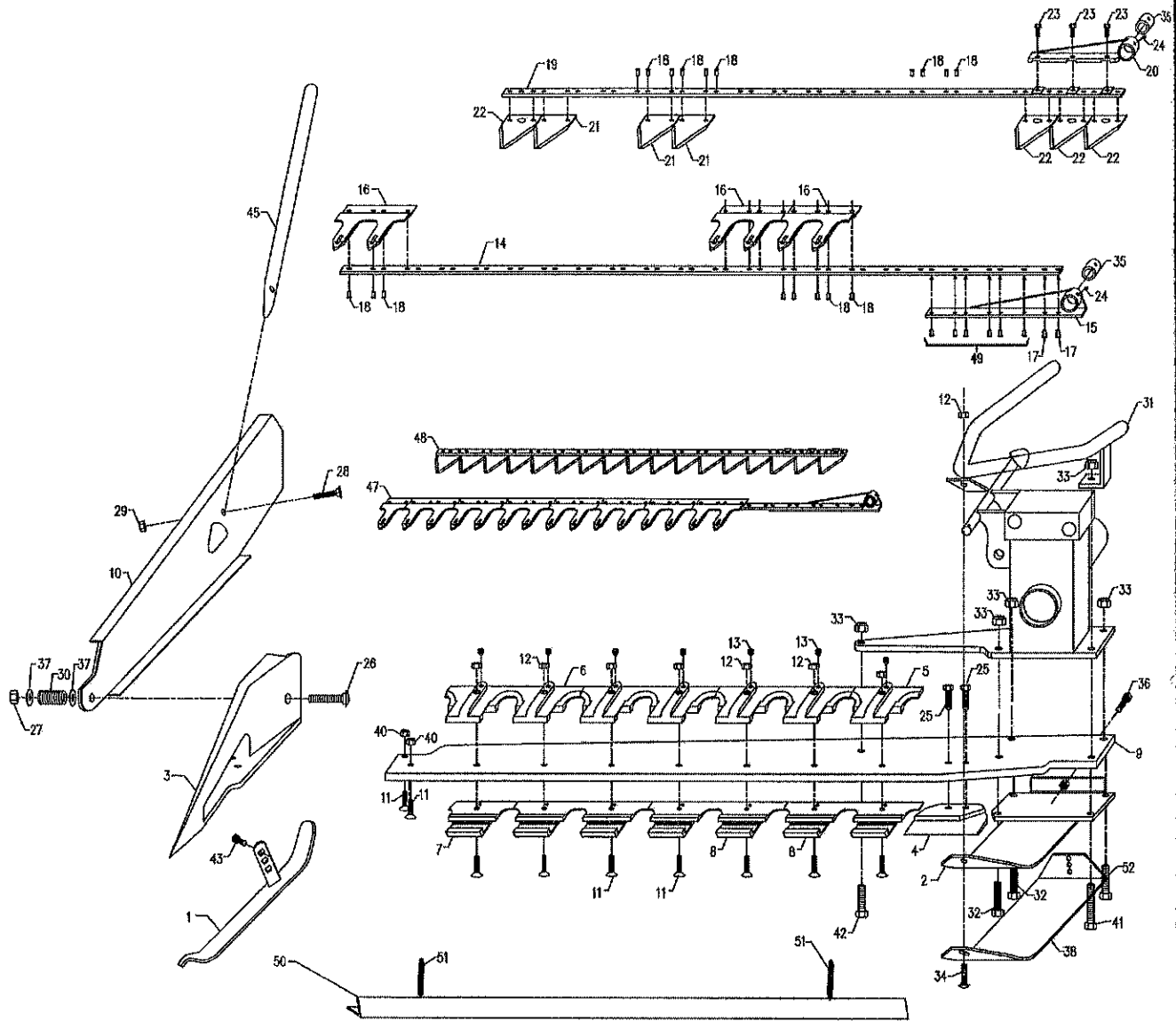

Ref.	Part #	Description	Qty.
1	N00-1515	Skid shoe, external	1
2	N00-1785	Internal runner	1
3	N00-1510	Support, outer bar	1
4	N00-1550	Lower blade guide	1
5	N00-1505	Single upper blade guide	-
6	N00-1506	Double upper blade guide	-
7	N00-1502	Single lower blade guide	-
8	N00-1501	Double lower blade guide	-
9	N00-2865	Blade support bar; BSB-060	-
10	N00-1525	Swath board	1
11	N00-C1030	Bolt CS M10-1.50x55 C10.9 Z F	-
12	000-1279	Nut HH M10-1.50 C6 Z TK	-
13	N00-C2055	Set screw M12x16	-
14	N00-1650	Tooth bar; BSB-060	-
15	N00-1545	Teeth head	1
16	N00-C2060	Double blade tooth	-
17	N00-C2050	Rivet Ø7x19	-
18	N00-C2051	Rivet Ø6x12	-
19	N00-1665	Rod section; BSB-060	-
20	N00-1530	Section head	1
21	N00-C2065	Section	-
22	N00-C2066	Section with central hole	-
23	N00-C1156	Bolt HF M08-1.25x16 C8.8 Z F	3
24	005-1129	Grease fitting M06-1.00	2
25	009-1281	Bolt HH M10-1.50x35 C8.8 Z F	2
26	005-7375	Bolt CR M12-1.75x80 C4.6 Z	1
27	001-3345	Nut ES M12-1.75 Z TK	1
28	501-623B	Bolt CR M08-1.25x40 C4.6 Z	1
29	009-1384	Nut ES M08-1.25 Z TK	1
30	N00-2032	Lateral deflector spring	1
31	N00-1575	Protection	1
32	003-0277	Bolt HH M14-2.00x60 C8.8 Z P	2
33	000-7224	Nut ES M14-2.00 Z TK	5
34	N00-C1032	Bolt CR M10-1.50x40 C4.6 Z	1
35	N00-1535	Bushing	2
36	001-5255	Bolt HH M12-1.75x30 C8.8 Z F	1
37	000-2265	Washer, flat Ø12x24x2.5	2
38	N00-1790	Skid shoe, internal	1
40	001-4106	Nut ES M10-1.50 Z TK	3
41	N00-C1014	Bolt CS M14-2.00x70 C10.9 Z F	1
42	003-7349	Bolt HH M14-2.00x45 C8.8 Z F	1
43	003-3176	Bolt HH M10-1.50x25 C8.8 Z F	1
45	N00-1582	Wooden deflector tube	-
47	N00-2880	Complete teeth bar, 10 teeth; BSB-060	-
48	N00-2895	Complete blade, 19 sections; BSB-060	-
49	N00-C2052	Rivet Ø6x20	-
50	N00-2907	Teeth guard; BSB-060	-
51	N00-2900	Traction spring guard	-
52	N00-C1015	Bolt CS M14-2.00x60 C10.9 Z F	1

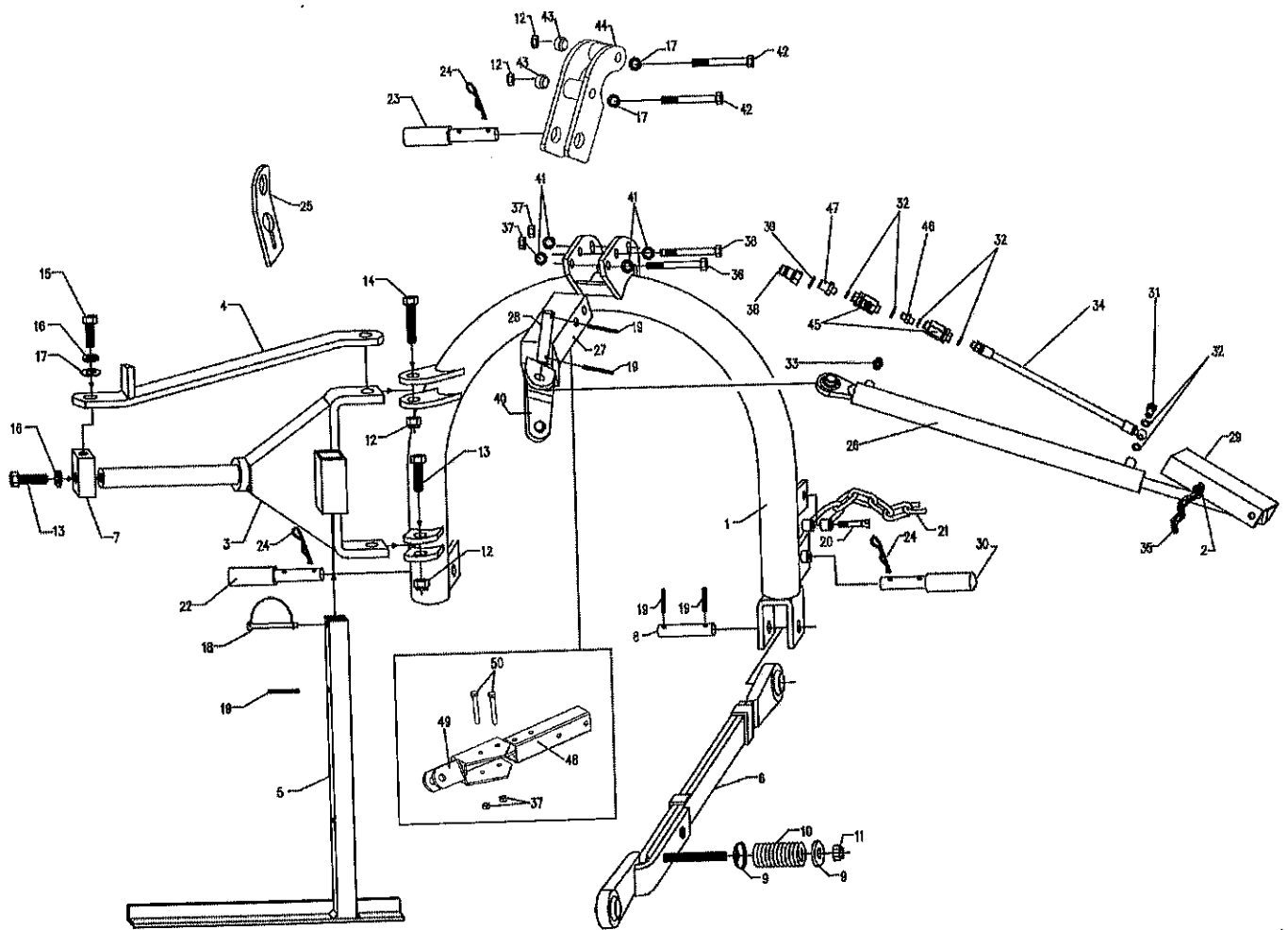

Ref.	Part #	Description	Qty.
1	N00-2035	Three point hitch arch	1
2	005-0165	Nut ES M06-1.00 Z TK	1
3	N00-2016	Frame shaft	1
4	N00-2012	Frame shaft rod	1
5	N00-2020	Support stand	1
6	N00-2065	Safety release	1
7	N00-2025	Mounting shaft	1
8	N00-2060	Safety release pin	1
9	N00-2067	Washer lock SP Ø14	2
10	N00-2066	Release spring	1
11	000-7224	Nut ES M14-2.00 Z TK	1
12	002-6314	Nut ES M16-2.00 Z TK	2
13	005-1965	Bolt HH M16-2.00x65 C8.8 Z P	2
14	N00-C1002	Bolt HH M16-2.00x80 C8.8 Z P	1
15	003-2687	Bolt HH M16-2.00x40 C8.8 Z F	1
16	000-2367	Washer lock Ø16 Z	2
17	001-7354	Washer fender Ø16 Z	1
18	N00-C2082	Pin Ø8	2
19	502-625B	Roll pin Ø6x50	4
20	N00-C2080	Shackle M12	1
21	N00-C2094	Chain (20 chain links)	1
22	N00-C2180	Arm attachment pin 22-28	1
23	N00-C2086	Three point hitch pin 19-25	1
24	009-1507	Hairpin cotter Ø4 Z	3
25	N00-2087	Tractor coupling plate	1
26	N00-2069	Cylinder	1
27	N00-2042	Arm, complete; BSB-074, 084, 096, 106 #289769 & above	1
28	N00-2075	Cylinder attachment pin	1
29	N00-2078	Cylinder stop w/bolt M6x25 & nut; #289769 & above	1
30	N00-2145	Three point hitch pin 22-28 long	1
31	N00-C1046	Bolt hollow 1/4"x1.00 Z	1
32	005-2438	Washer copper 1/4"	6
33	007-9341	Breather cap 1/4"	1
34	N00-C2148	Hydraulic hose 1/4"x2000; #289769 & above	1
35	N00-C2097	Small chain 18 chain links	1
36	003-4286	Bolt HH M12-1.75x100 C8.8 Z P	2
37	001-3345	Nut ES M12-1.75 Z TK	4
38	004-1871	Quick coupler 1/2"	1
39	003-6532	Washer copper 1/2"	1
40	N00-2120	Cylinder attachment lever	1
41	000-2265	Washer flat Ø12 W	4
42	007-0346	Bolt HH M16-2.00x110 C8.8 Z P	2
43	N00-2255	Centering washer	2
44	N00-2260	Quick hitch adapter bracket	1
45	N00-C1866	Flow regulation valve 1/4"; #289769 & above	2
46	008-2484	Adapter 1/4" - 1/4"	1
47	008-2488	Adapter 1/4" - 1/2"	1
48	N00-2043	Arm; BSB-074, 084, 096, 106 #289769 & above	1
49	N00-2044	Hitch, cylinder; BSB-074, 084, 096, 106 #289769 & above	1
50	001-5122	Bolt HH M12-1.75x90 C8.8 Z P	2

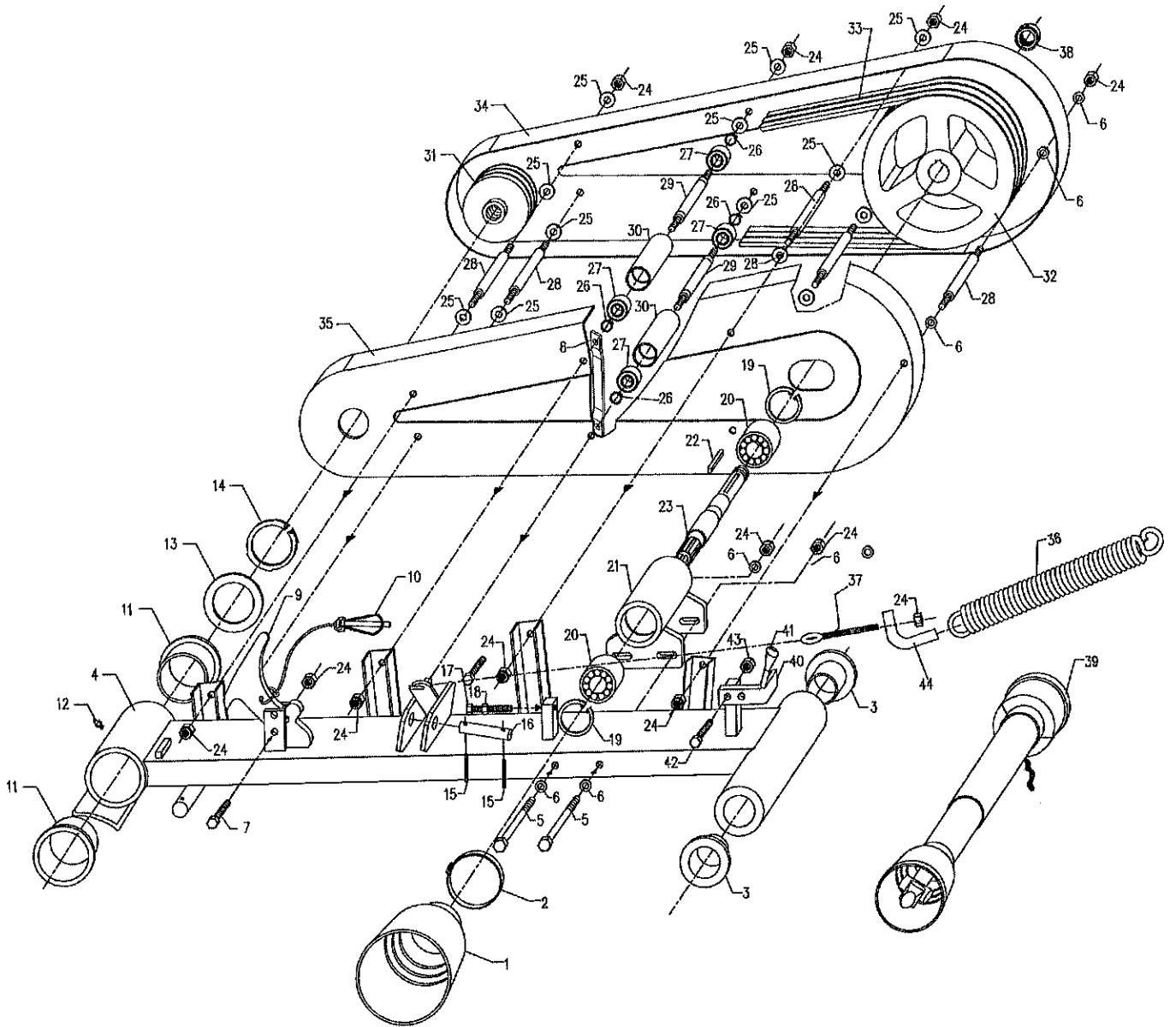

BSB-074, BSB-084, BSB-096, BSB-106 SERIAL #289769 & ABOVE

Ref.	Part #	Description	Qty.
1	N00-C2090	Yellow cone	1
2	N00-C2089	Cone ring	1
3	N00-2515	Frame shaft bushing	2
4	N00-2526	Main frame bar	1
5	N00-C1026	Bolt HH M12-1.75x135 C8.8 Z P	2
6	000-2265	Washer Ø12x24x2.5	4
7	000-7716	Bolt HH M12-1.75x45 C8.8 Z F	1
8	N00-2566	Internal plate	1
9	N00-2555	Lever	1
10	N00-C2088	Lynch pin Ø10 with chain	1
11	N00-2520	Main frame attachment bushing	2
12	005-1129	Grease fitting M06-1.00	1
13	N00-2580	Main frame attachment washer	1
14	N00-C2203	Snap ring, outer Ø90	1
15	502-625B	Roll pin Ø6x50	2
16	N00-2060	Safety release pin	1
17	000-7128	Bolt HH M12-1.75x80 C8.8 Z F	1
18	001-7223	Nut HH M12-1.75 C6 Z TN	1
19	002-5329	Snap ring, inner Ø72	2
20	503-197B	Bearing 6207 2RS	2
21	N00-2510	Pulley - Shaft support (support only)	1
22	N00-C2093	Key Ø8x60	1
23	N00-2505	Shaft	1
24	001-3345	Nut ES M12-1.75 Z TK	16
25	007-6106	Washer flat Ø12x36x3	19
26	005-0145	Snap ring, outer Ø20	4
27	003-6761	Bearing 6004 2RS	4
28	N00-2560	Joint pin	5
29	N00-2561	Joint pin (inner roller)	2
30	N00-2565	Roller (roller only)	2
31	N00-2536	Pulley SPB 130x3	1
32	N00-2531	Pulley SPB 320x3	1
33	005-7269	Belt SPB 2500	3
34	N00-2545	External cover	1
35	N00-2550	Internal cover	1
36	N00-2500	Spring	1
37	N00-C2091	Eye bolt M12x120	1
38	003-0095	Locking ring ES GUK M30-1.50	1
39	N00-C2597	Driveline B3x1100E	1
40	N00-2593	Three point stop	1
41	N00-C1078	Knob Ø12	1
42	003-0331	Bolt HH M10-1.50x50 C8.8 Z F	1
43	000-1279	Nut HH M10-1.50 C6 Z TK	1
44	N00-2612	Spring attachment; #289769 & above	1
	N00-2635	Complete roller assembly	-
	N00-2640	Complete shaft and support assembly	-

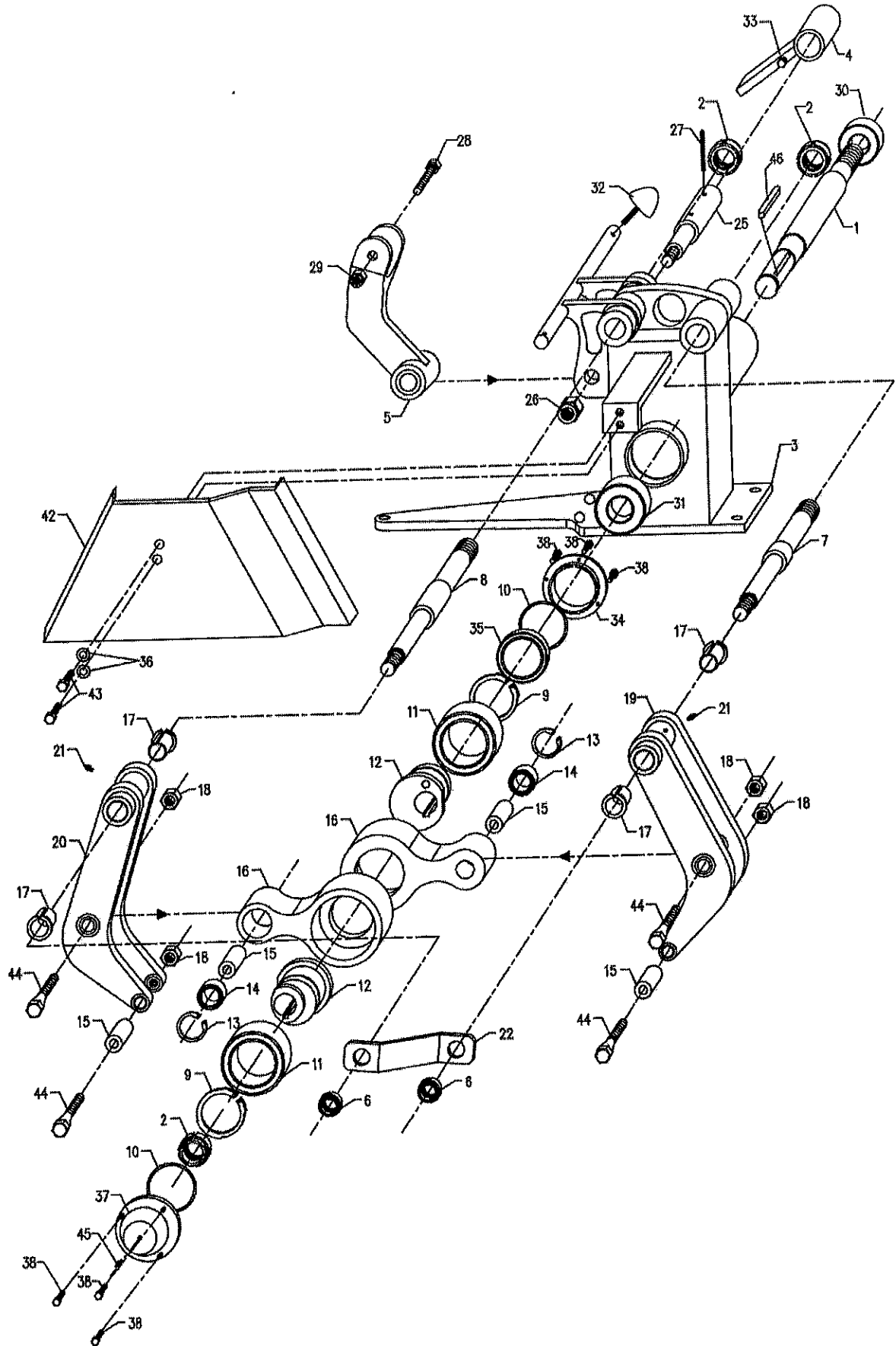

BSB-074, BSB-084, BSB-096, BSB-106 SERIAL #289769 & ABOVE

Ref.	Part #	Description	Qty.
1	N00-1000	Hinge eccentric shaft	1
2	003-0095	Locking ring ES GUK M30-1.50	3
3	N00-1035	Support	1
4	N00-2570	Stop	1
5	N00-1063	Lift point lever; #289769 & above	1
6	N00-C2101	Locking ring ES GUK M20-1.00	2
7	N00-1050	Teeth bar arm shaft	1
8	N00-1025	Blade bar arm shaft	1
9	3120134	Snap ring, outer Ø65	2
10	N00-C2201	O-ring 2375	2
11	N00-C2250	Bearing 6013 Z	2
12	N00-1005	Hinge eccentric	2
13	005-0144	Snap ring, inner Ø47	2
14	N00-C2251	Bearing 3204 2RS	2
15	N00-1540	Bushing	4
16	N00-1010	Internal connector	2
17	N00-1045	Bushing	4
18	001-7223	Nut HH M12-1.75 C6 Z TN	4
19	N00-1020	Teeth bar arm	1
20	N00-1015	Blade bar arm	1
21	005-1129	Grease fitting M06-1.00	2
22	N00-1055	Support plate	1
25	N00-1065	Lever lift pin	1
26	002-6314	Nut ES M16-2.00 Z TK	1
27	502-625B	Roll pin Ø6x50	1
28	003-4265	Bolt HH M12-1.75x65 C8.8 Z P	1
29	001-3345	Nut ES M12-1.75 Z TK	1
30	005-0212	Bearing 6306 2RS	1
31	503-197B	Bearing 6207 2RS	1
32	N00-C1080	Stop-block M8	1
33	502-720B	Bolt HH M06-1.00x25 C8.8 Z F	1
34	N00-1087	Oil seal ring	1
35	000-7805	Oil seal 65-85-10	1
36	001-4514	Washer fender Ø8 Z	2
37	N00-1100	Protection plug	1
38	003-6319	Bolt HH M06-1.00x16 C8.8 Z F	6
42	N00-1123	Connector protection cover	1
43	004-6454	Bolt HH M08-1.25x16 C8.8 Z F	2
44	N00-2098	Conic bolt	4
45	005-3155	Grease fitting 90° M06-1.00	1
46	N00-C2095	Key 8x70	1
	N00-1135	Complete connectors	-

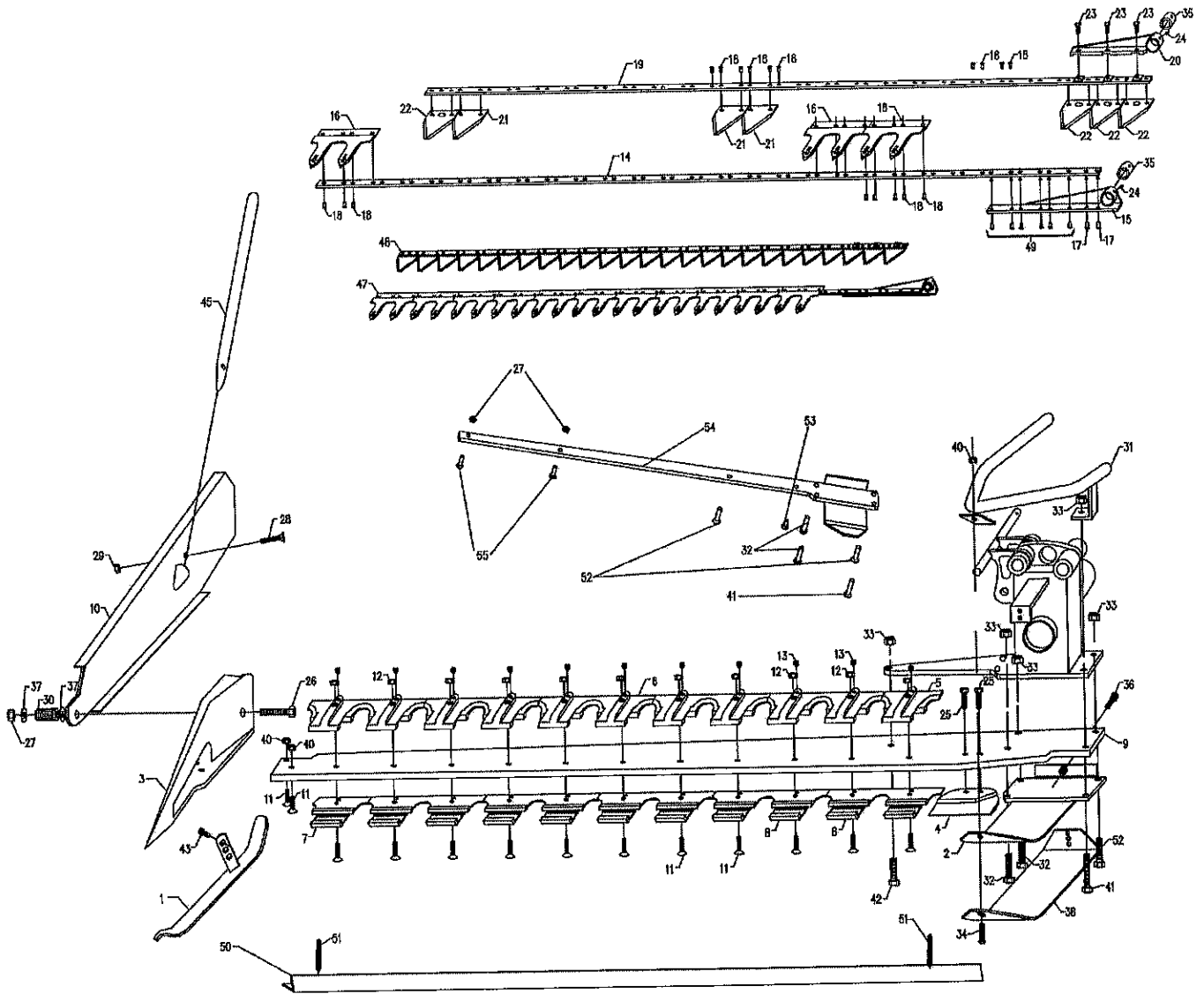

BSB-074, BSB-084, BSB-096, BSB-106 SERIAL #289769 & ABOVE

Ref.	Part #	Description	Qty.
1	N00-1515	Skid shoe, external	1
2	N00-1785	Internal runner; BSB-074, BSB-084	1
3	N00-1510	Outer bar support	1
4	N00-1550	Lower blade guide	1
5	N00-1505	Single upper blade guide	-
6	N00-1506	Double upper blade guide	-
7	N00-1502	Single lower blade guide	-
8	N00-1501	Double lower blade guide	-
9	N00-1520	Blade support bar 74"; BSB-074	-
	N00-1523	Blade support bar 84"; BSB-084	-
	N00-1519	Blade support bar 96"; BSB-096	-
	N00-1760	Blade support bar 106"; BSB-106	-
10	N00-1525	Swath board	1
11	N00-C1030	Bolt CS M10-1.50x55 C10.9 Z F	-
12	000-1279	Nut HH M10-1.50 C6 Z TK	-
13	N00-C2055	Set screw M12x16	-
14	N00-1560	Tooth bar 74"; BSB-074	-
	N00-1562	Tooth bar 84"; BSB-084	-
	N00-1563	Tooth bar 96"; BSB-096	-
	N00-1695	Tooth bar 106"; BSB-106	-
15	N00-1545	Teeth head	1
16	N00-C2060	Double blade tooth	-
17	N00-C2050	Rivet Ø7x19	-
18	N00-C2051	Rivet Ø6x12	-
19	N00-1555	Rod section 74" (bored rod); BSB-074	-
	N00-1557	Rod section 84" (bored rod); BSB-084	-
	N00-1558	Rod section 96" (bored rod); BSB-096	-
	N00-1693	Rod section 106" (bored rod); BSB-106	-
20	N00-1530	Section head	1
21	N00-C2065	Section	-
22	N00-C2066	Section with central hole	-
23	N00-C1156	Bolt HF M08-1.25x16 C8.8 Z F	3
24	005-1129	Grease fitting M06-1.00	2
25	009-1281	Bolt HH M10-1.50x35 C8.8 Z F	2
26	005-7375	Bolt CR M12-1.75x80 C4.6 Z	1
27	001-3345	Nut ES M12-1.75 Z TK	1
28	501-623B	Bolt CR M08-1.25x40 C4.6 Z	1
29	009-1384	Nut ES M08-1.25 Z TK	1
30	N00-2032	Spring, lateral deflector	1
31	N00-1575	Protection	1
32	003-0277	Bolt HH M14-2.00x60 C8.8 Z P	2
33	000-7224	Nut ES M14-2.00 Z TK	5
34	N00-C1032	Bolt CR M10-1.50x40 C4.6 Z	1
35	N00-1535	Bushing	2
36	001-5255	Bolt HH M12-1.75x30 C8.8 Z F	1
37	000-2265	Washer flat Ø12 Z	2
38	N00-1790	Skid shoe, internal	1
40	001-4106	Nut ES M10-1.50 Z TK	3

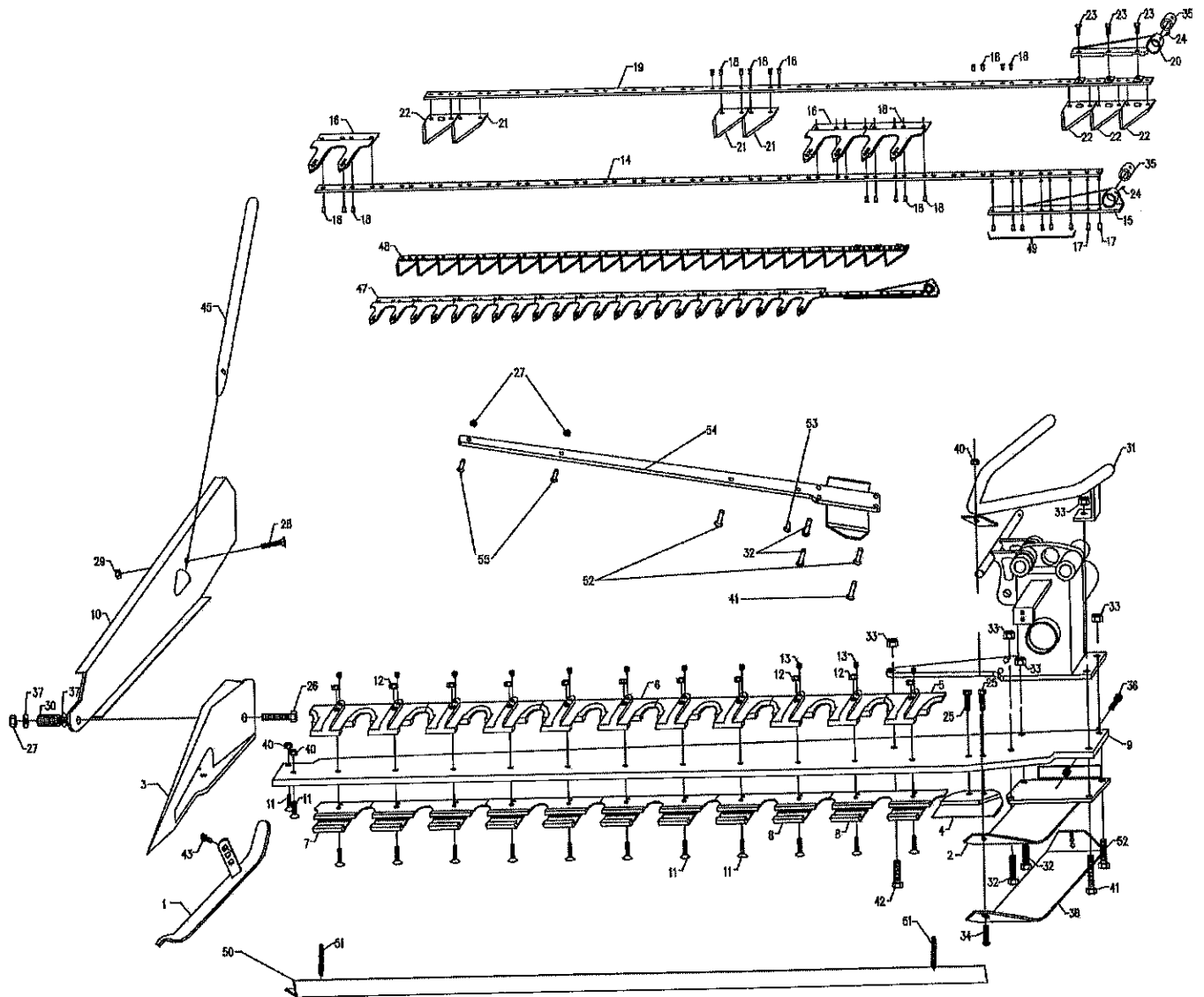

BSB-074, BSB-084, BSB-096, BSB-106 SERIAL #289769 & ABOVE

Ref.	Part #	Description	Qty.
41	N00-C1014	Bolt CS M14-2.00x70 C10.9 Z F	1
42	003-7349	Bolt HH M14-2.00x45 C8.8 Z F	1
43	003-3176	Bolt HH M10-1.50x25 C8.8 Z F	1
45	N00-1582	Wooden deflector tube	1
47	N00-1611	Complete teeth bar 13 teeth; BSB-074	-
	N00-1612	Complete teeth bar 14 teeth; BSB-084	-
	N00-1613	Complete teeth bar 16 teeth; BSB-096	-
	N00-1690	Complete teeth bar 17 teeth; BSB-106	-
48	N00-1616	Blade 25 sections; BSB-074	-
	N00-1617	Blade 27 sections; BSB-084	-
	N00-1618	Blade 31 sections; BSB-096	-
	N00-1685	Blade 33 sections; BSB-106	-
49	N00-C2052	Rivet Ø6x20	-
50	N00-2910	Teeth guard 74" & 84"; BSB-074, BSB-084	-
	N00-2912	Teeth guard 96"; BSB-096	-
	N00-2915	Teeth guard 106"; BSB-106	-
51	N00-2900	Traction spring guard	2
52	N00-C1015	Bolt CS M14-2.00x60 C10.9 Z F	2
53	004-4023	Bolt CS M12-1.75x30 C10.9 Z F	1
54	N00-1780	Internal runner; BSB-096, BSB-106	2
55	002-0227	Bolt CS M12-1.75x45 C10.9 Z F	2
	950-213B	Decal "DANGER - Replace shields"	1
	950-109B	Decal "DANGER - Avoid injury from PTO"	1
	950-955B	Decal "DANGER - Sharp blades"	1
	950-407B	Decal "WARNING - Crushing and pinching hazard"	1
	950-408B	Decal "WARNING - High pressure hydraulic oil leaks"	1
	950-111B	Decal "CAUTION - Read Operator's Manual"	1
	950-463B	Decal "DANGER - Rotating driveline, keep away" outer shield	1
	950-464B	Decal "DANGER - Guard missing, do not operate" outer tube	1
	950-940B	Decal "Quick hitch compatible"	1
	950-106B	Decal "BEFCO"	1
	950-103B	Decal "B"	1
	950-308B	Decal "BSB"	1
	950-281B	Decal "074"	1
	950-304B	Decal "084"	1
	950-814B	Decal "096"	1
	950-376B	Decal "106"	1
	950-381B	Decal "BEFCO INC" address	1
	960-391B	Operator's & Parts Manual "Sickle bar BSB-060, 074, 084, 096, 106 #289769 & above"	1

Use only original spare parts

All rights reserved. It is unlawful to copy, reprint or use any of the information or details in this manual without the expressed written permission of the Company. Technical information provided in this manual is approximate, the Company reserves the right to modify or improve the models shown for technical or commercial purposes. Pictures in this manual do not necessarily show the machine as delivered.